



Montageanleitung Instrucciones de montaje	Mounting Instructions Istruzioni di montaggio	Instructions de montage Instruções de montagem	Bestell-Nr./Order No.: 8PQ9800-6AA73
--	--	---	--------------------------------------

Vor der Montage der Teile muss diese Anleitung gelesen und verstanden werden.
Read and understand these instructions before mounting the parts.
Avant le montage, veuillez lire attentivement les présentes instructions.
Antes del montaje de las piezas han de leerse y comprenderse estas instrucciones.
Le presenti istruzioni devono essere lette e comprese prima di eseguire il montaggio dei componenti.
Leia e compreenda estas instruções antes de montar as peças.

	GEFAHR Gefahr von Verletzung. Vor Beginn der Arbeiten Arbeitsschutz beachten.	DANGER Danger of injury. Take all industrial safety measures prior to starting the works.	DANGER Risque de blessure. Avant de commencer les opérations de montage, veuillez appliquer les consignes de sécurité.
	PELIGRO Riesgo de lesiones. Respete las protecciones laborales antes de comenzar el trabajo.	PERICOLO Pericolo di lesioni. Prima di iniziare verificare la sicurezza contro gli infortuni sul lavoro.	PERIGO Perigo de lesões. Antes de iniciar os trabalhos tenha atenção `aprotecção contra lesões.

Eine sichere Funktion ist nur mit zertifizierten Komponenten gewährleistet.
Reliable functioning of the equipment is only ensured with certified components.
Le fonctionnement sûr de l'appareil n'est garanti qu'avec des composants certifiés.
El funcionamiento seguro del aparato sólo está garantizado con componentes certificados.
Il funzionamento sicuro dell'apparecchiatura viene garantito soltanto con componenti certificati.
O funcionamento seguro do aparelho apenas pode ser garantido se forem utilizados os componentes certificados.

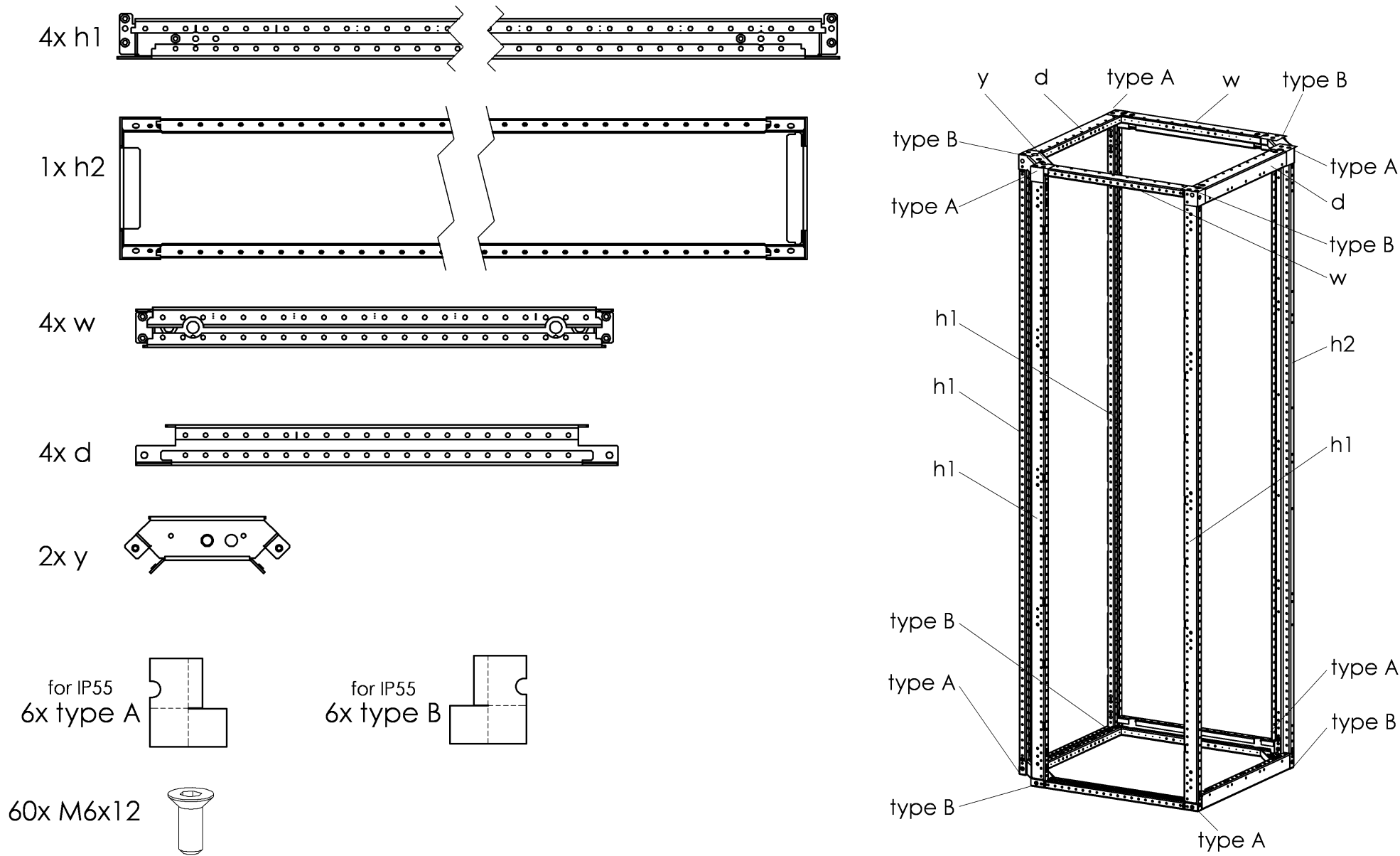

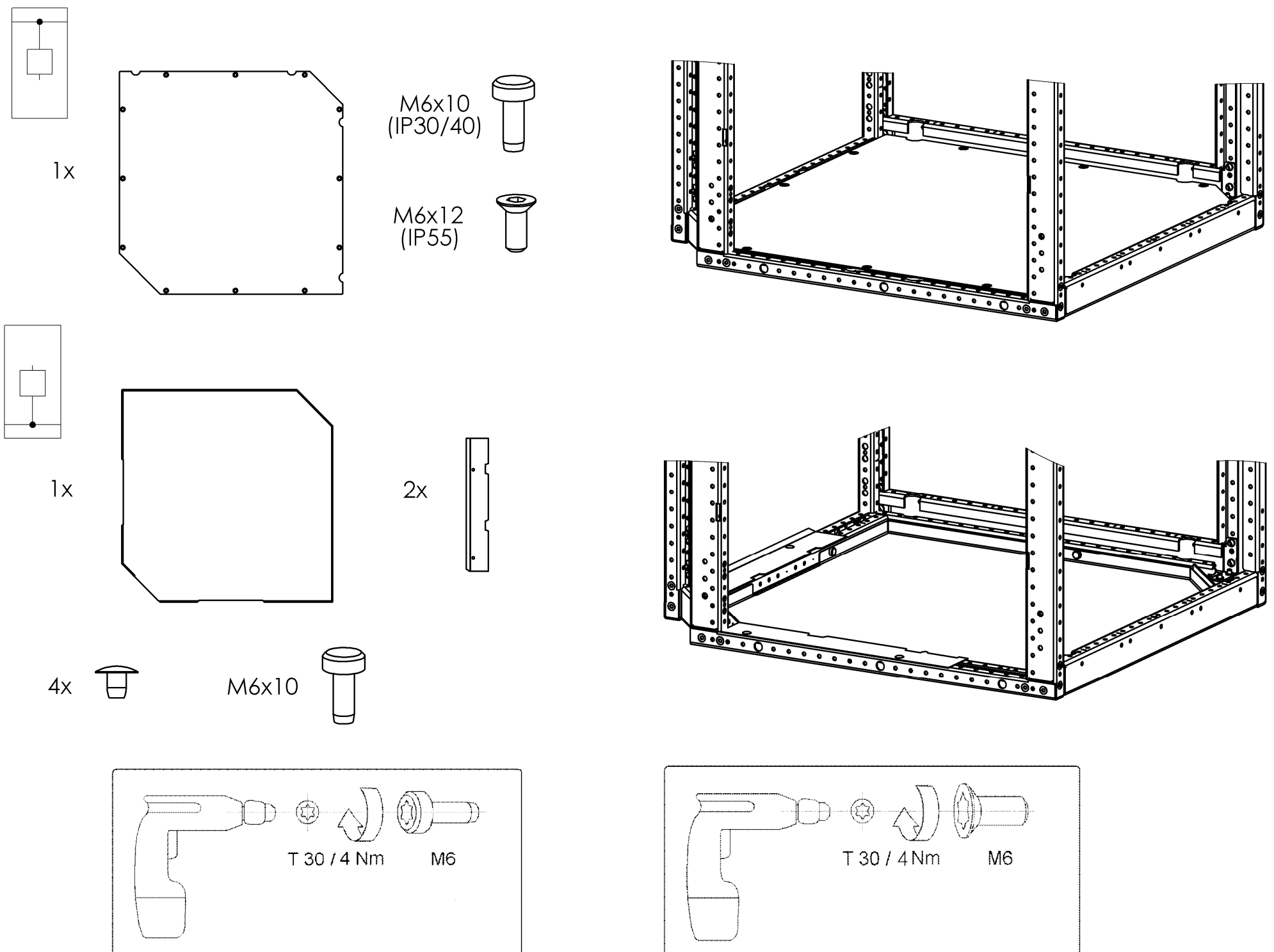
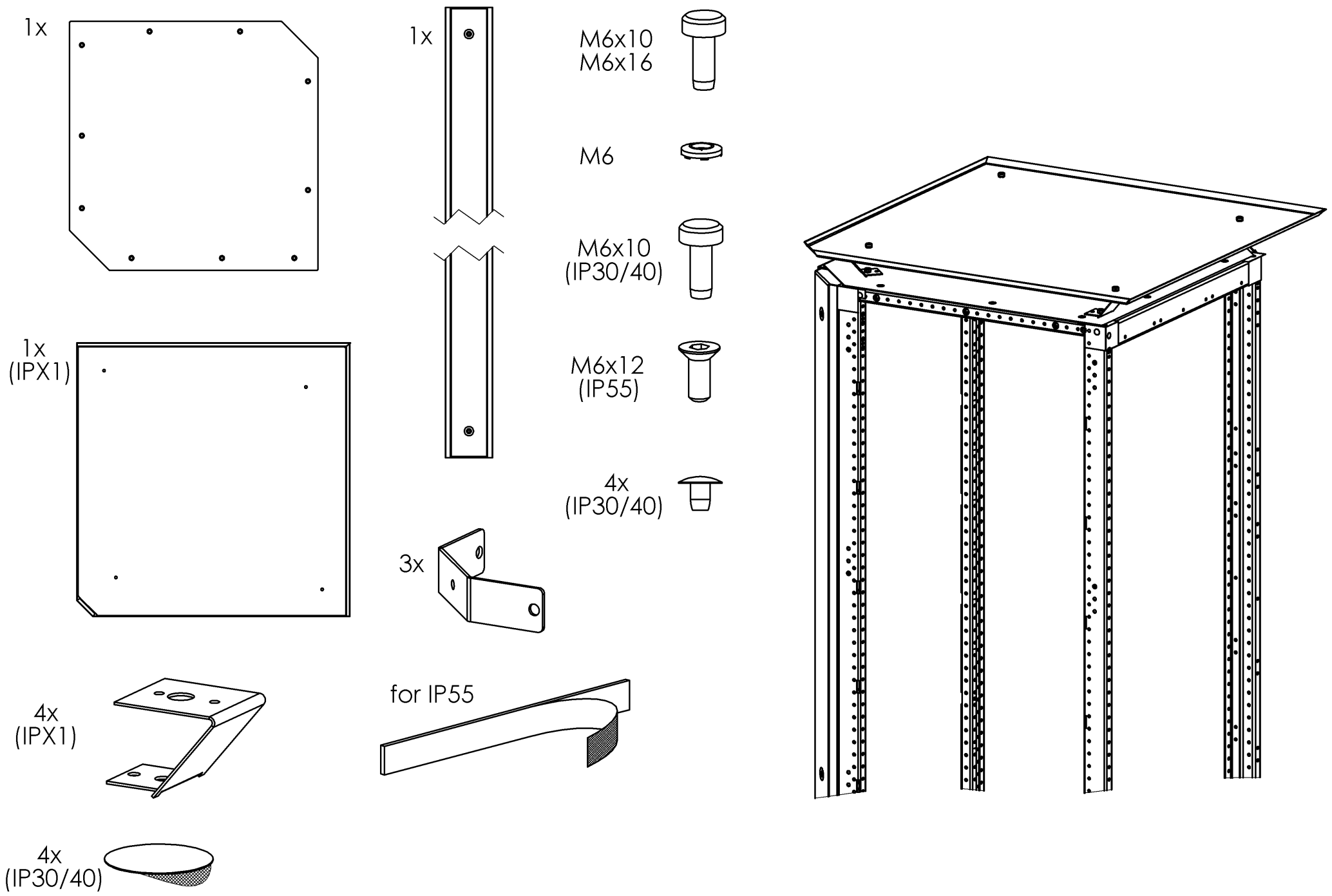

1

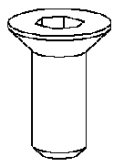

12x

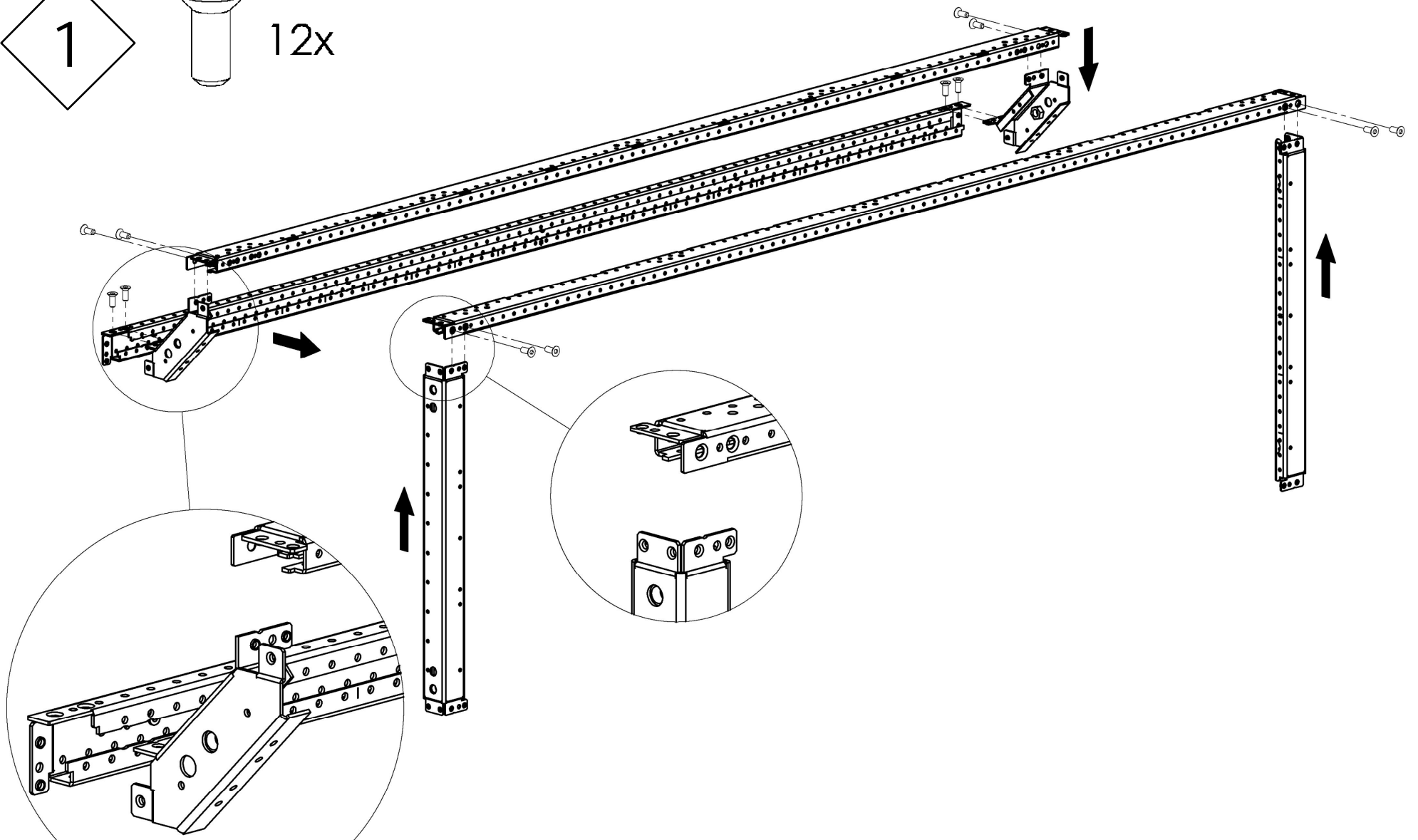

2

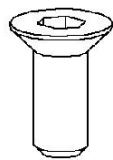

14x

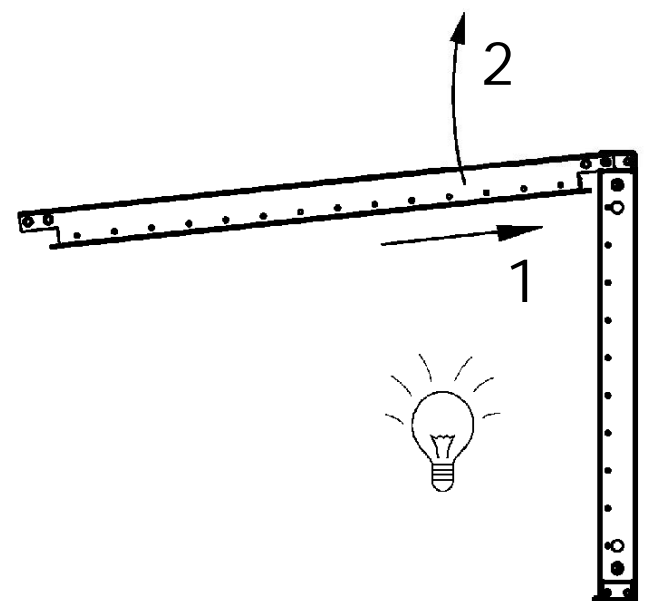
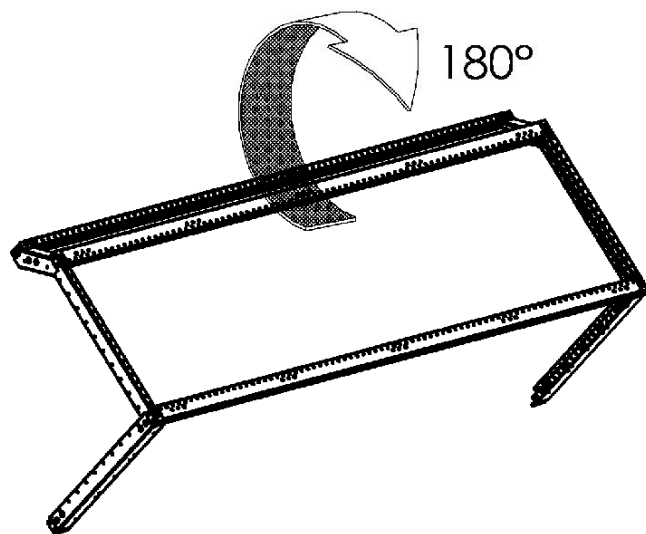
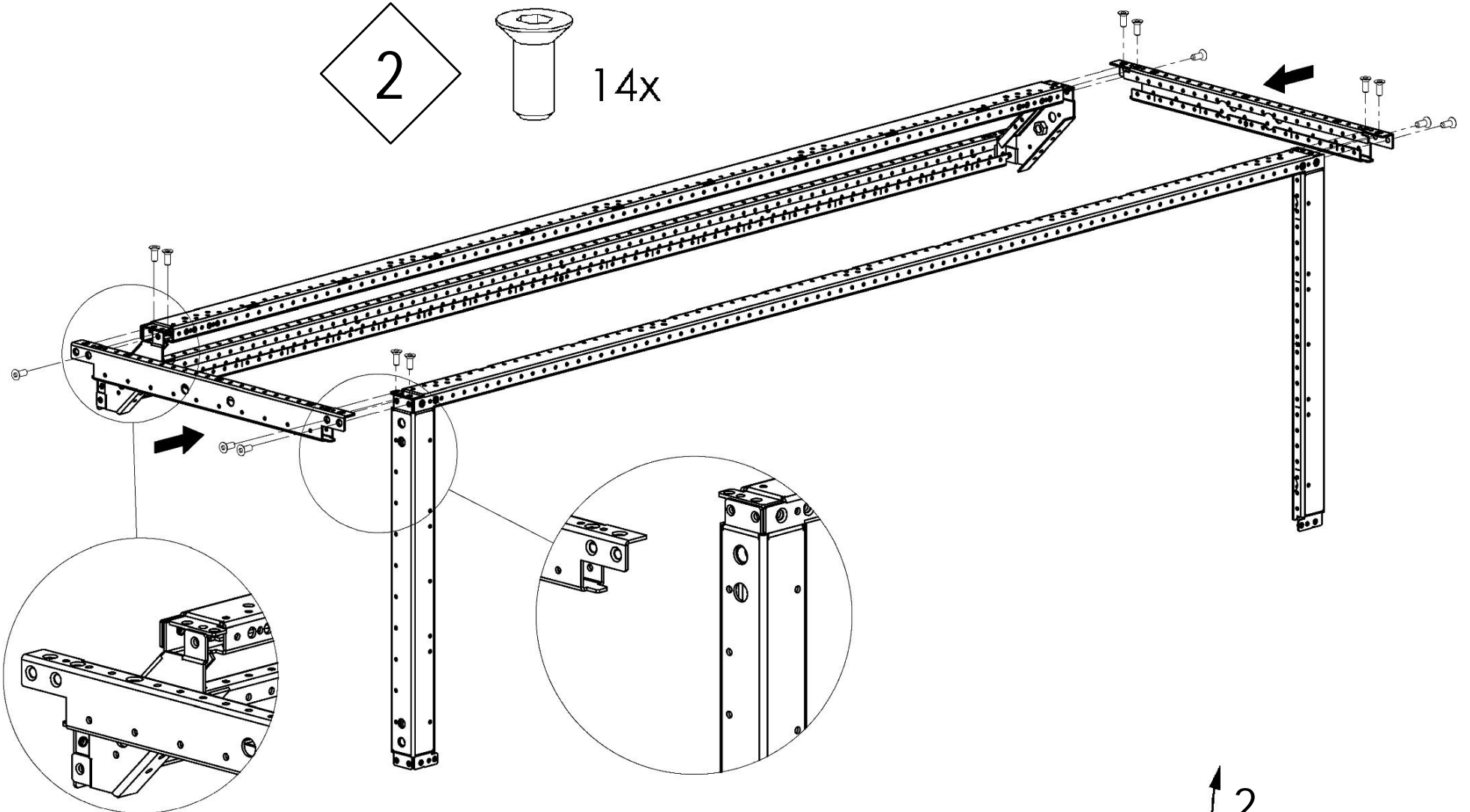

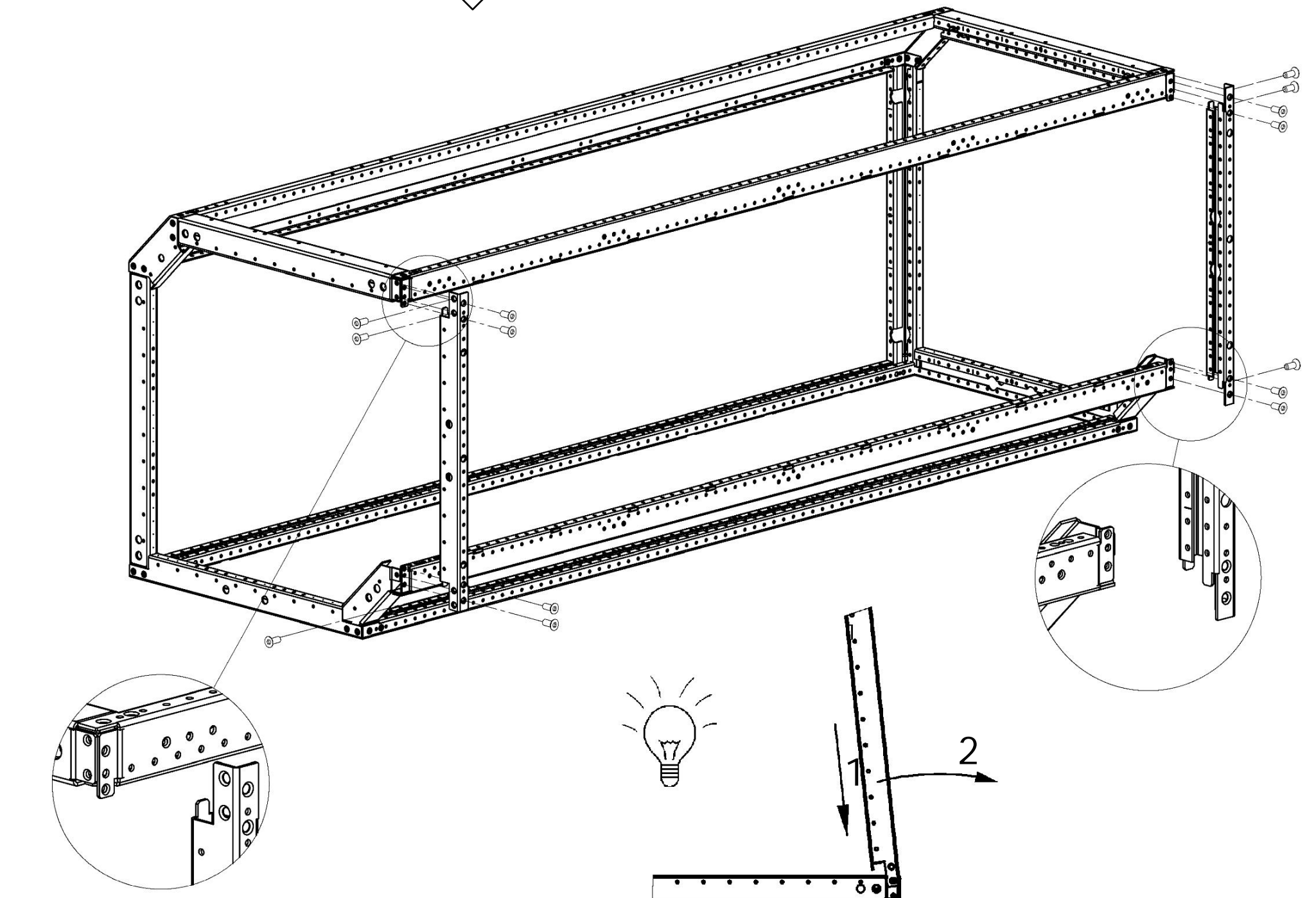
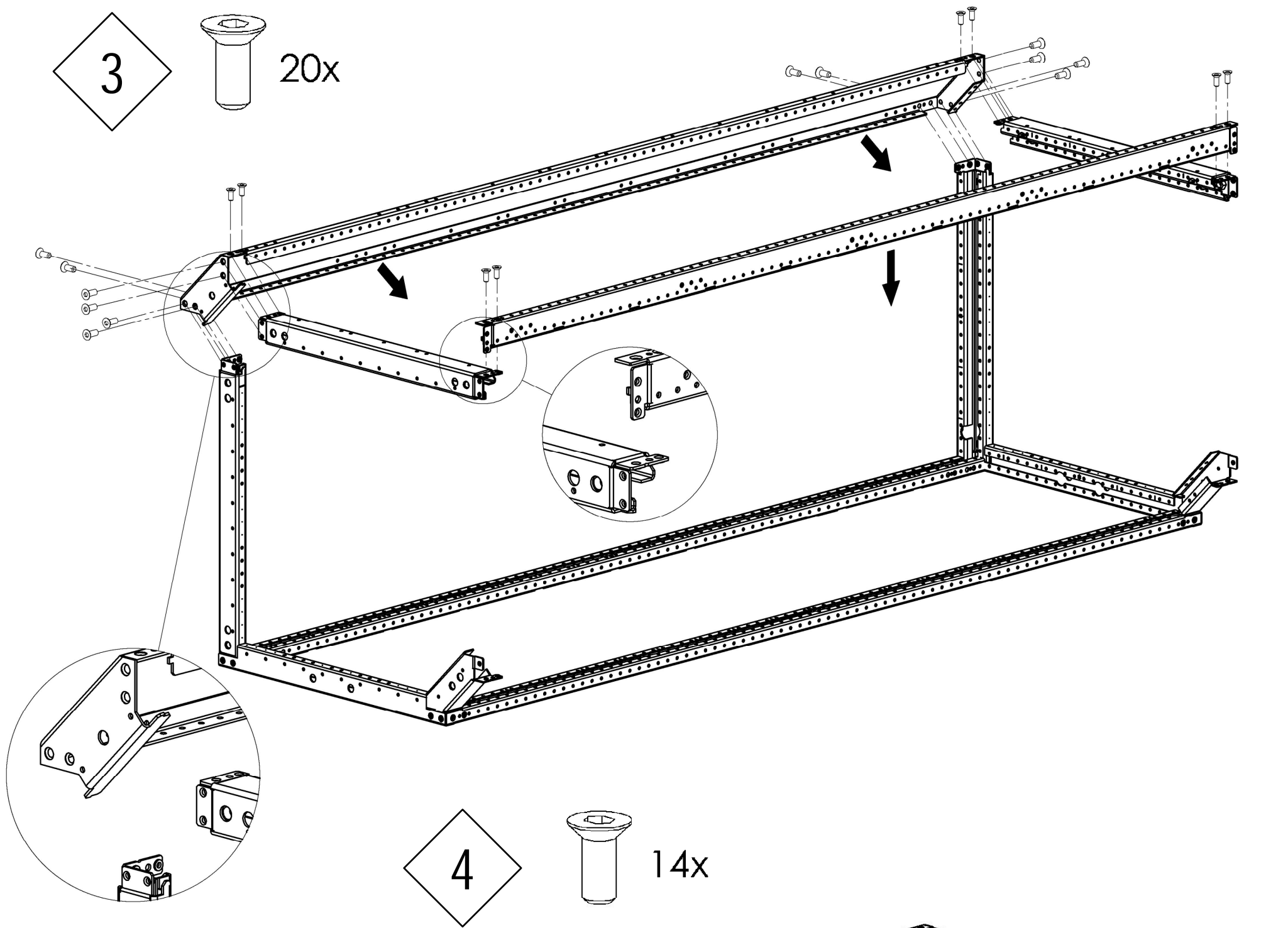

5

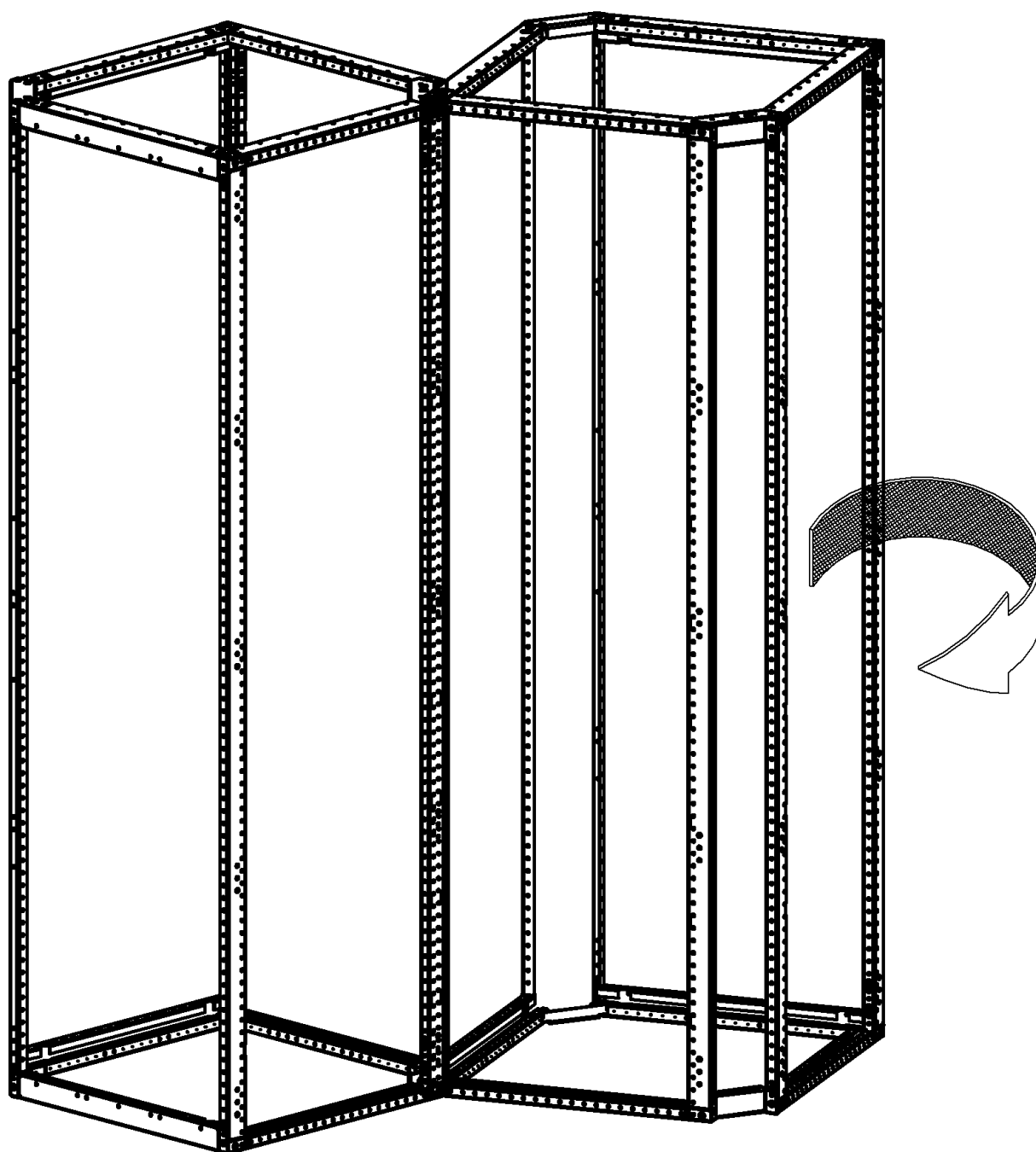
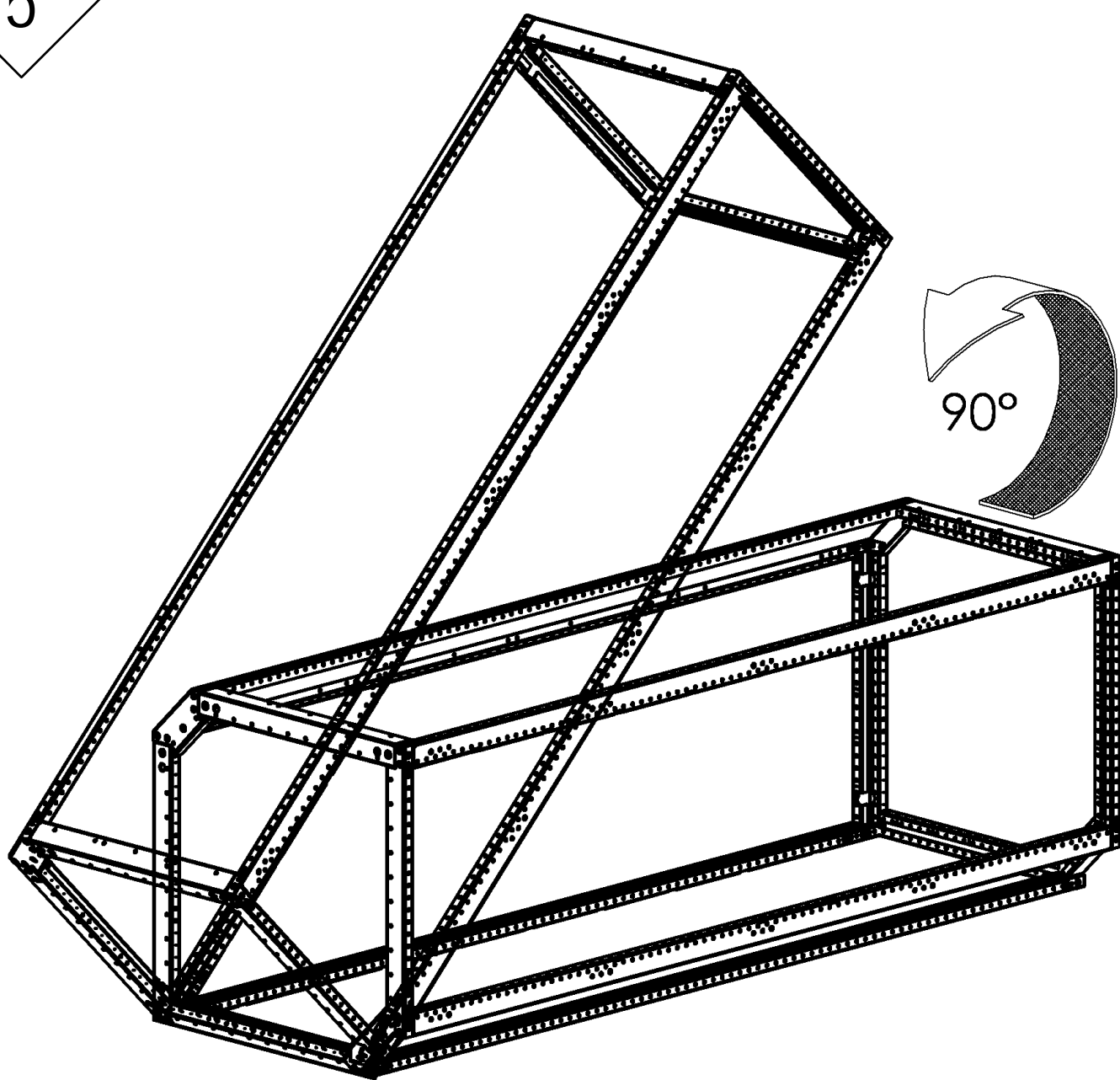

only for IP 55

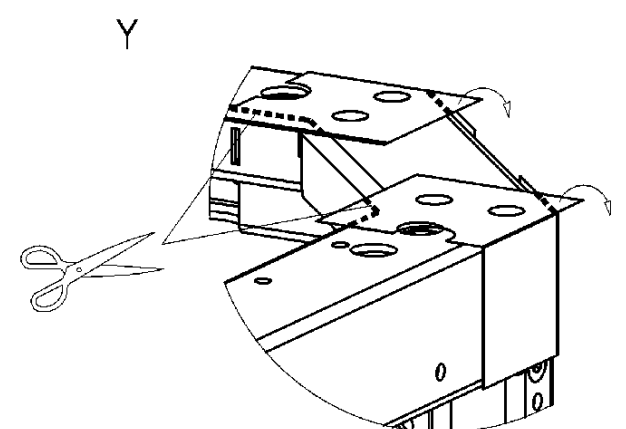
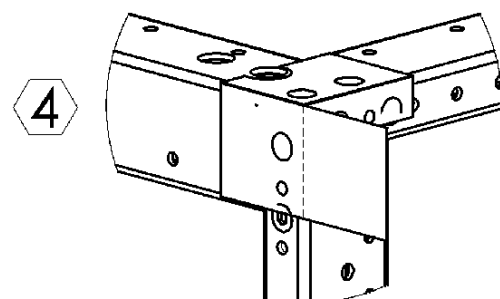
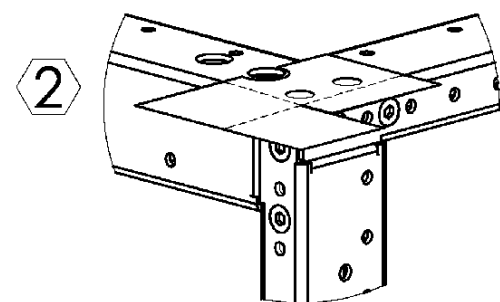
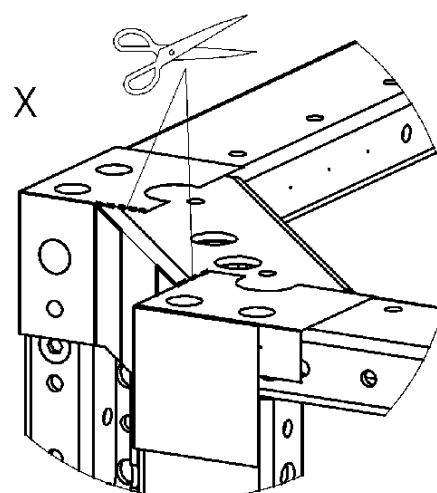
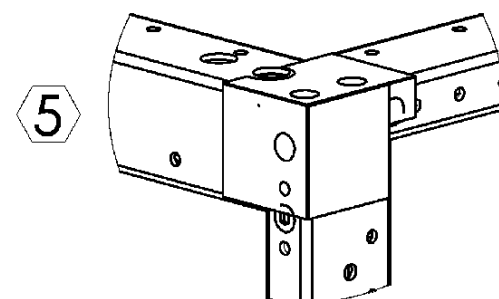
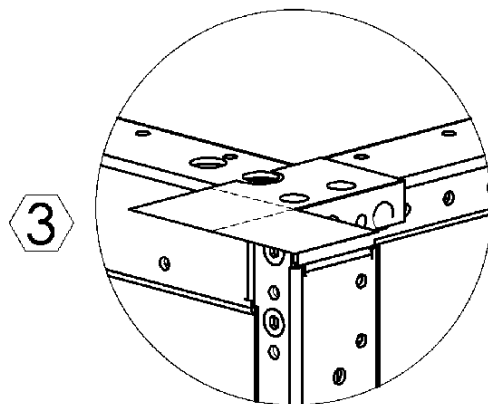
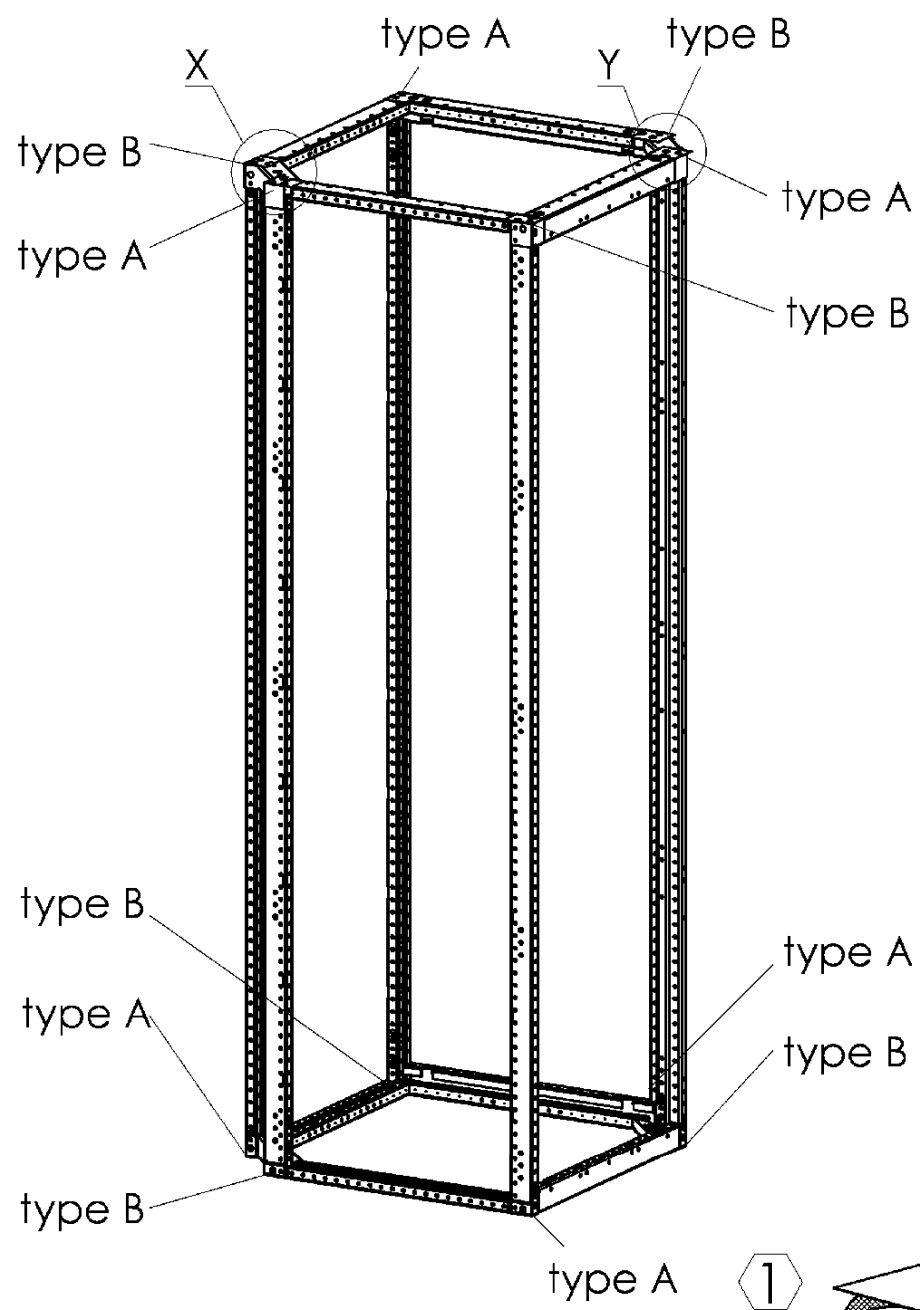

6

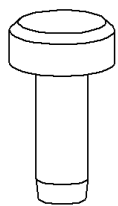

M6x10



4x

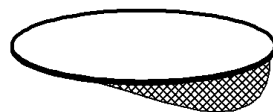

4x

IP30/40

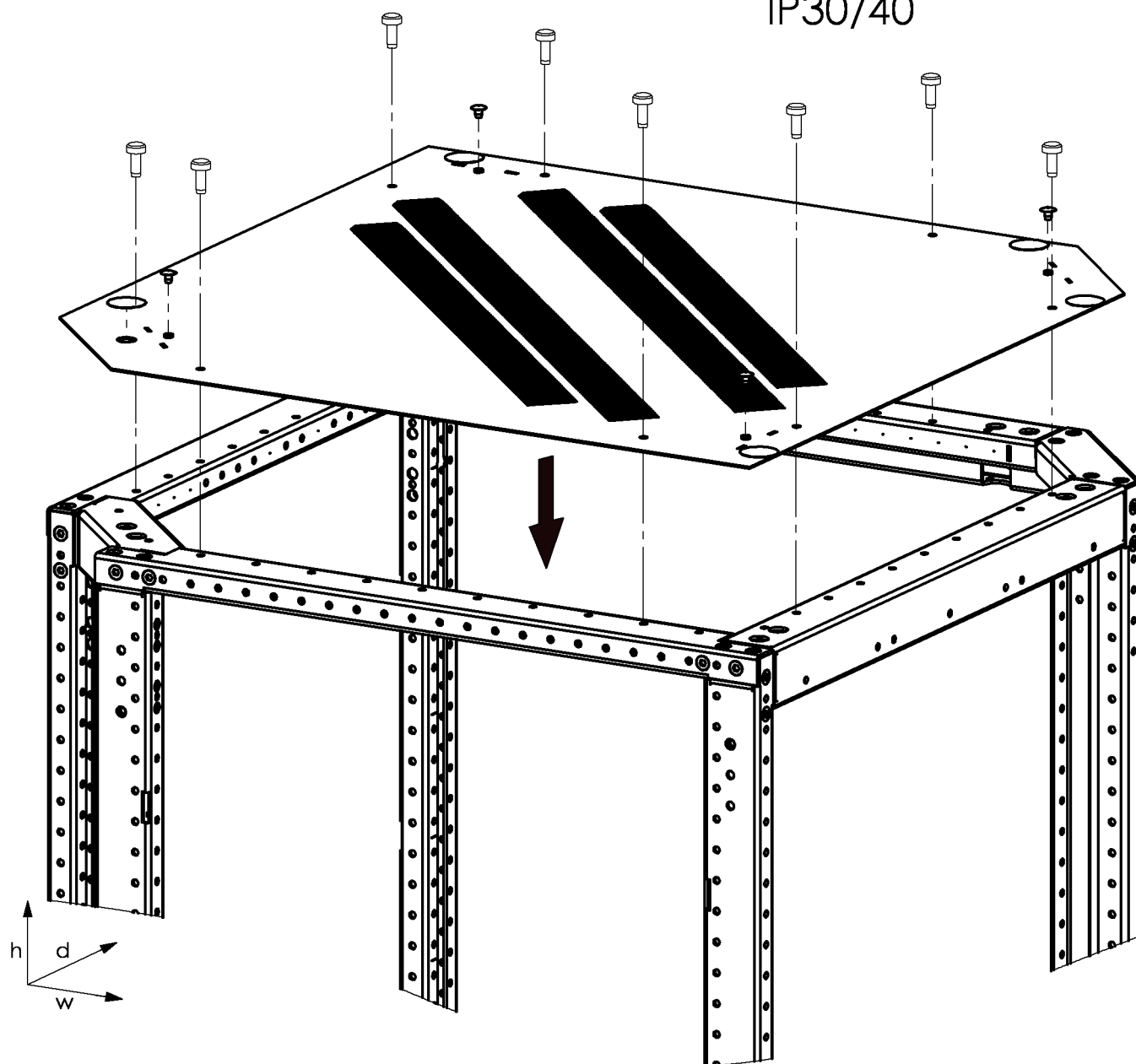

6

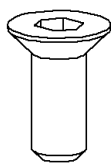

M6x12

IP55

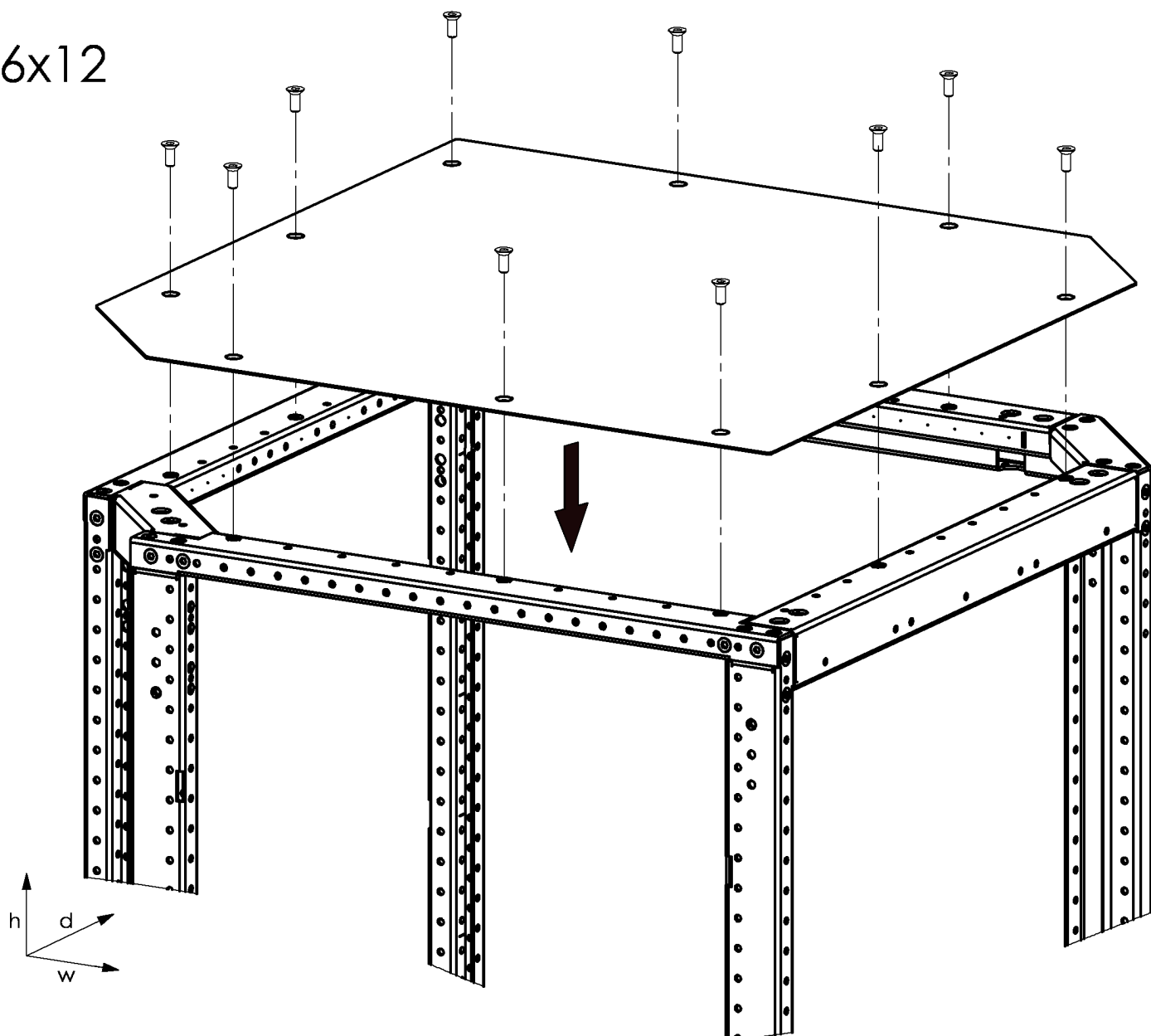

7

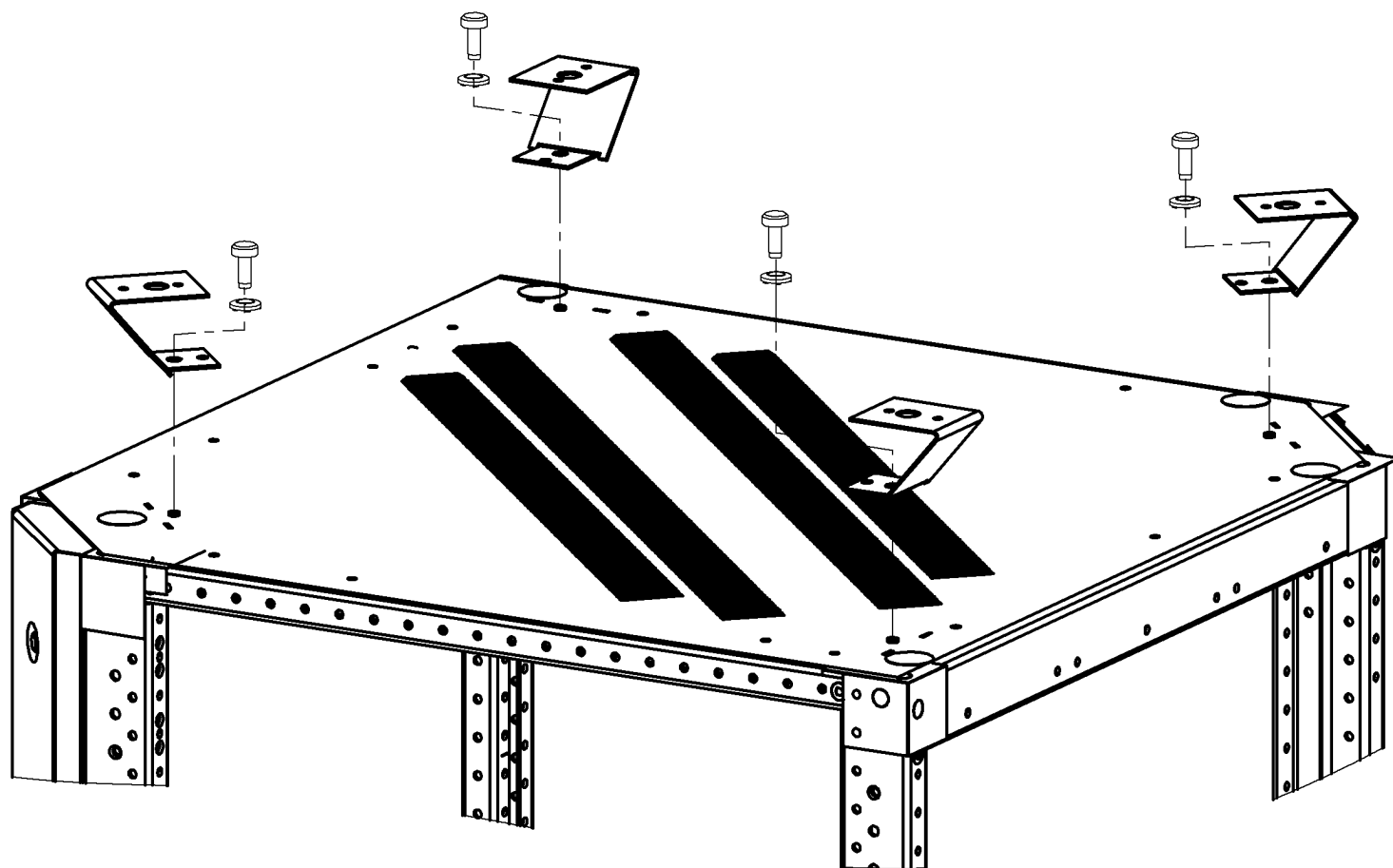
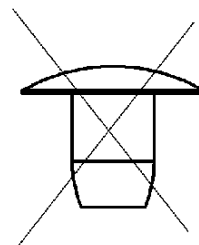
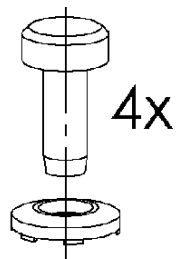

8

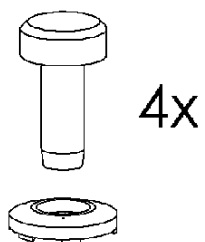

IPX1

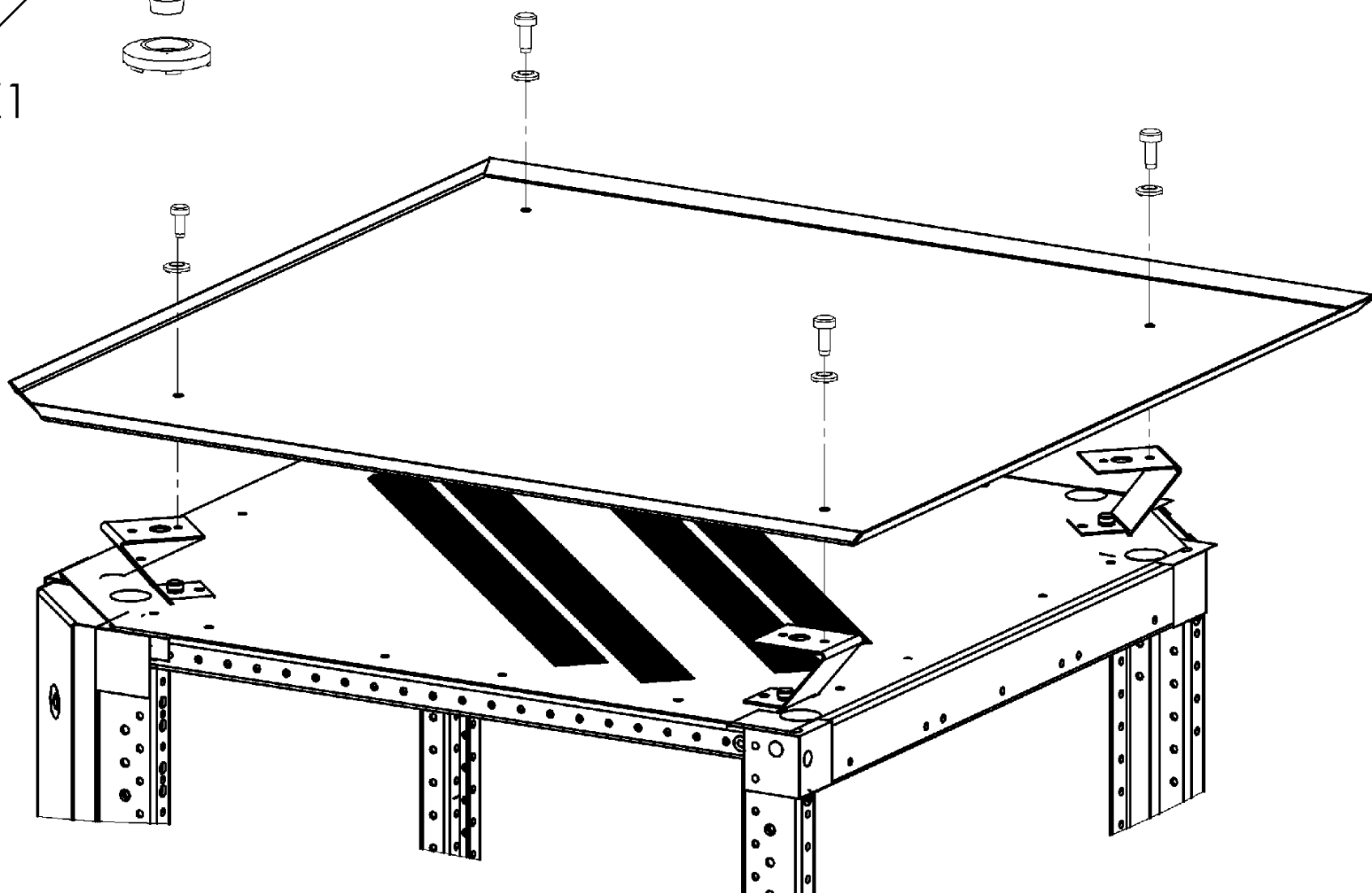

9

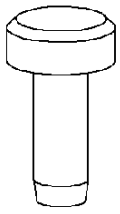

M6x10
(IP30/40)

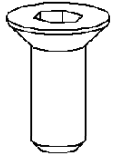
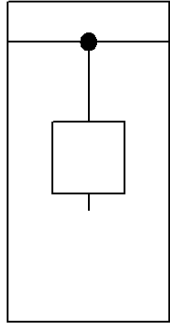

M6x12
(IP55)

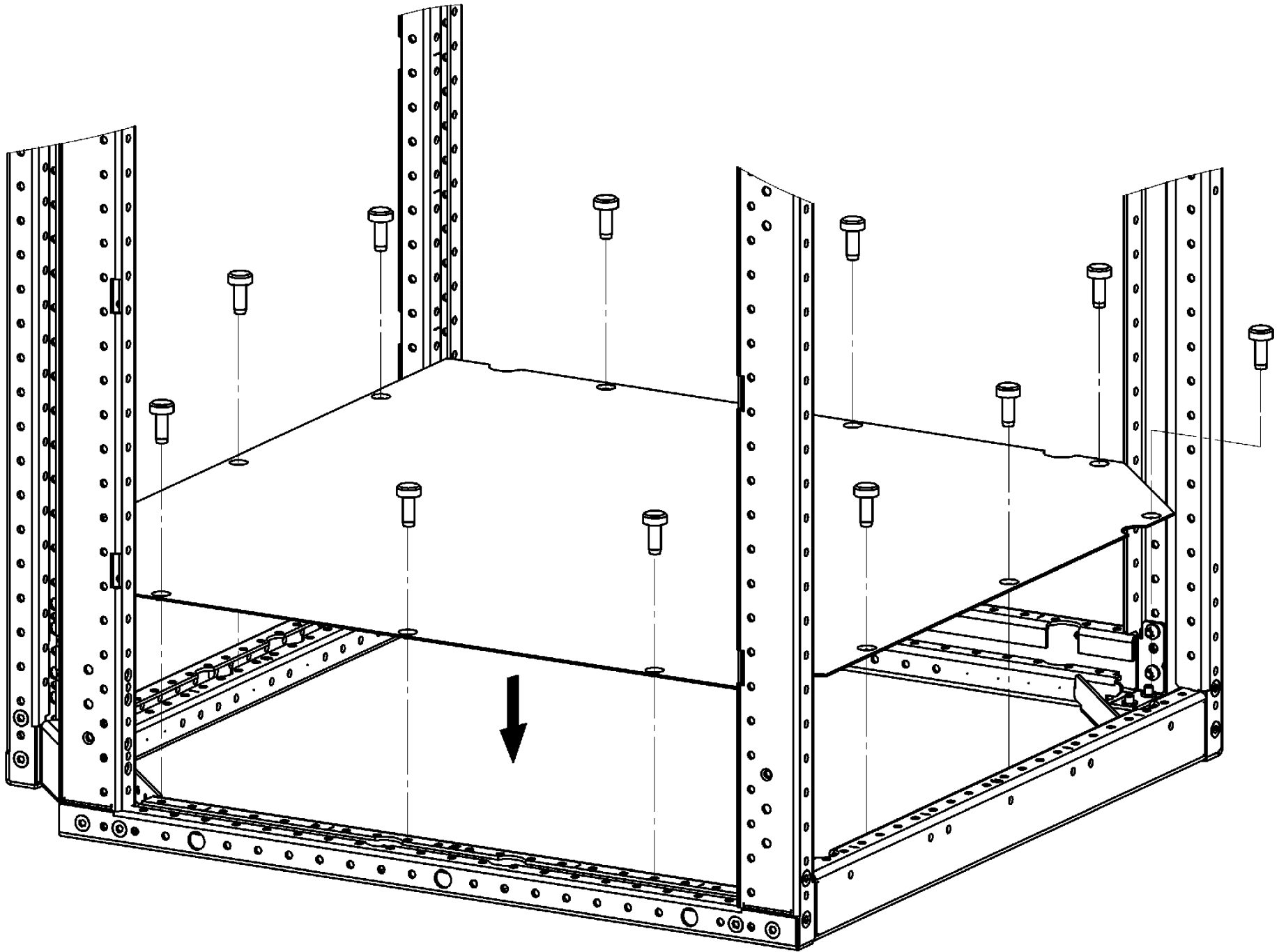

9

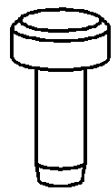

M6x10

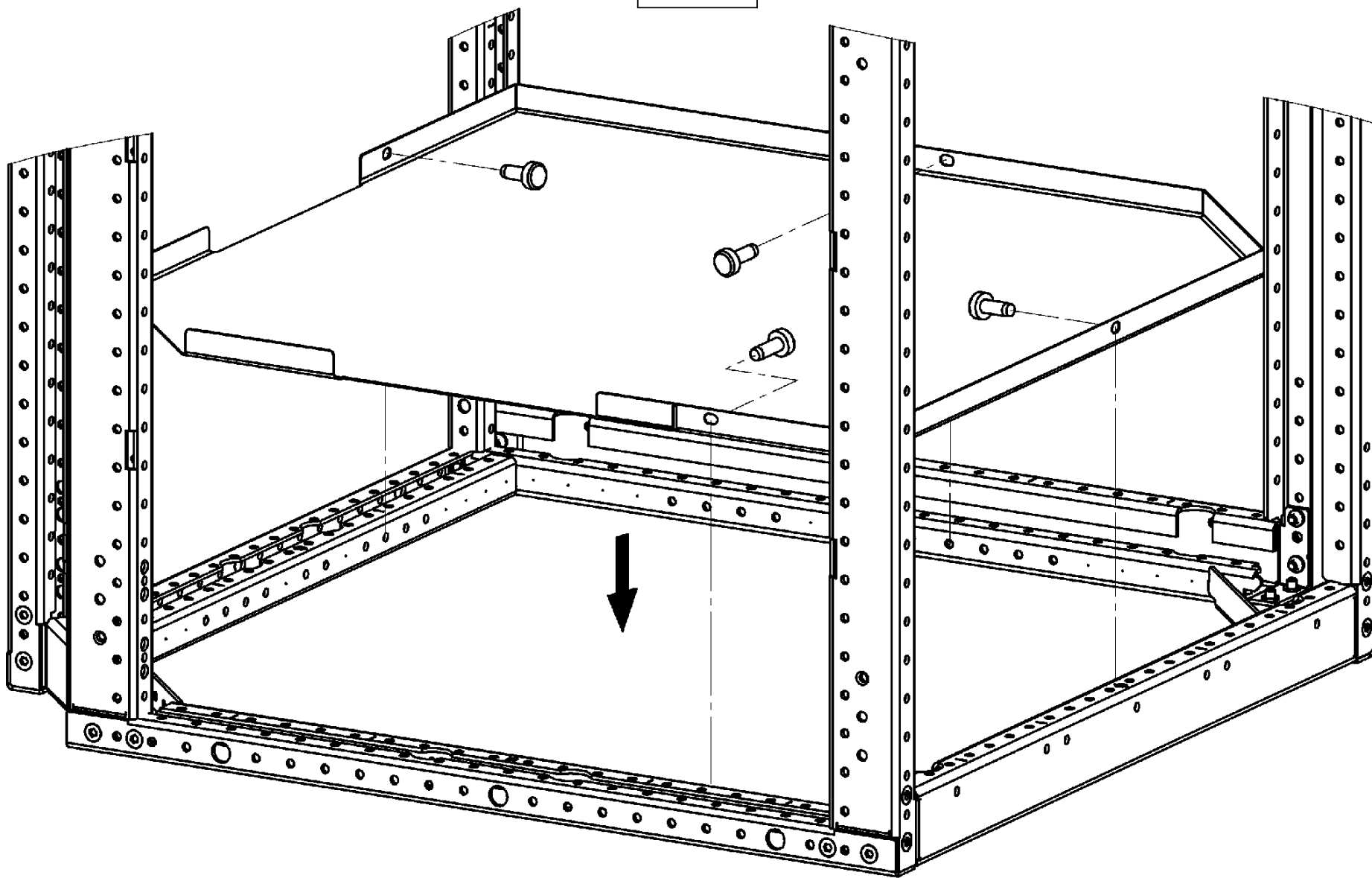
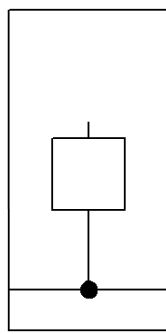

4x

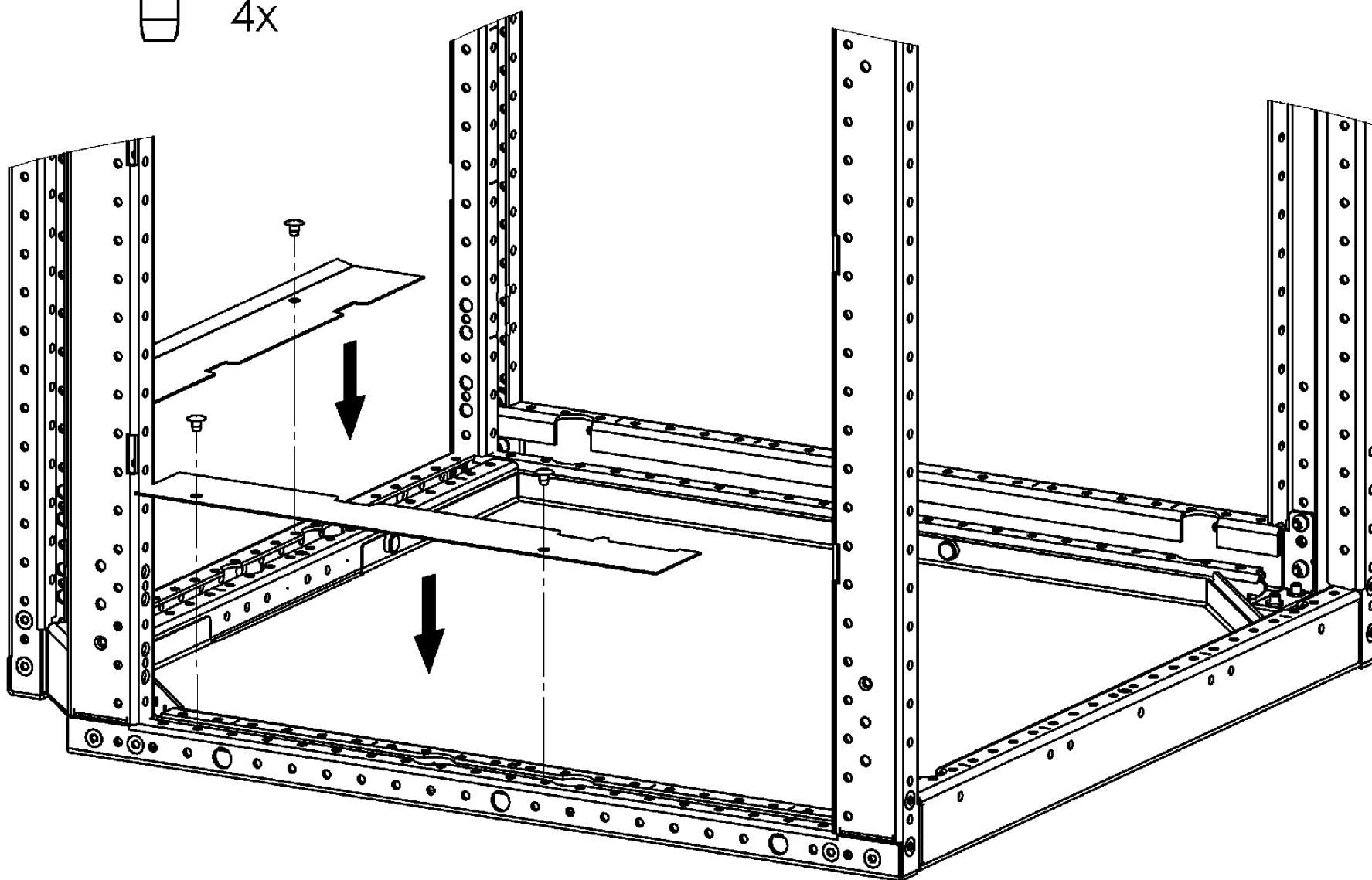

10

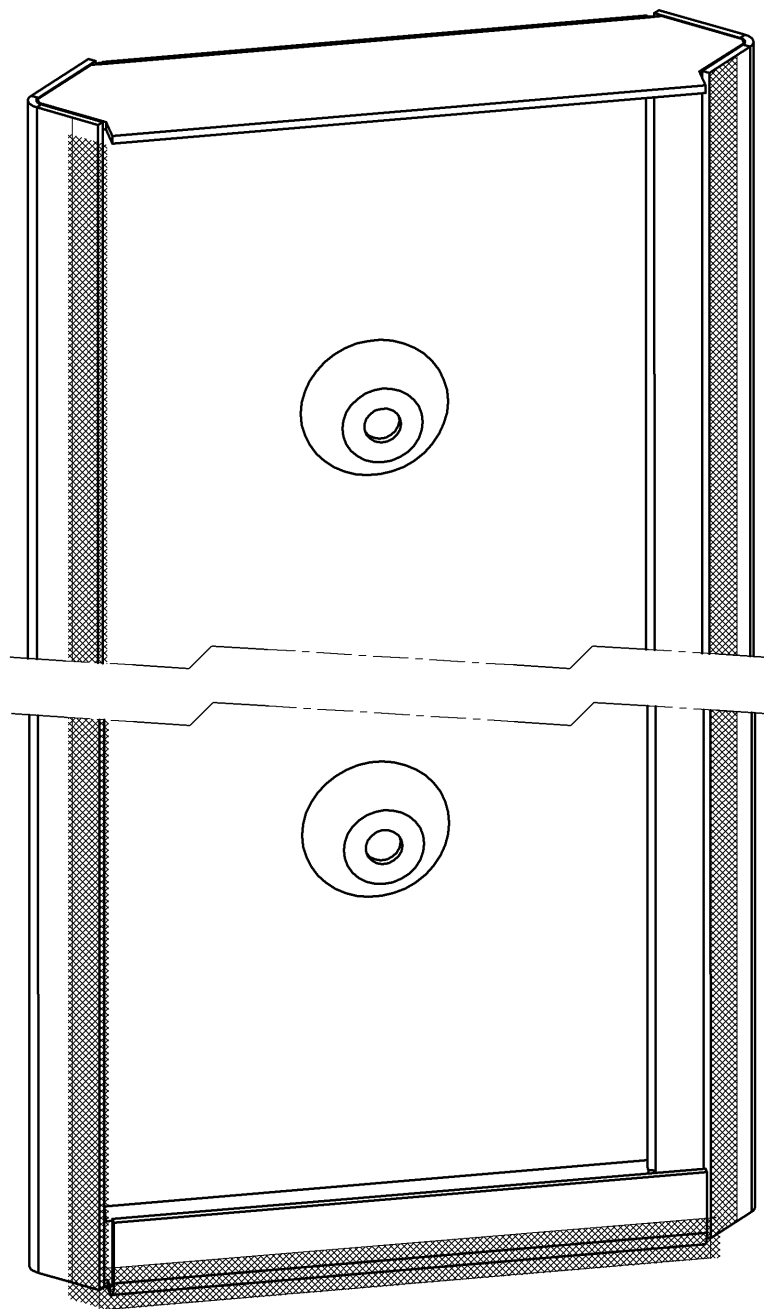
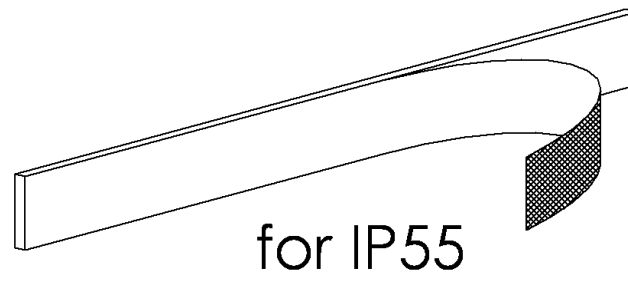

11

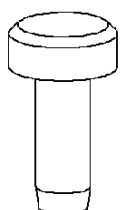

6x M6x10

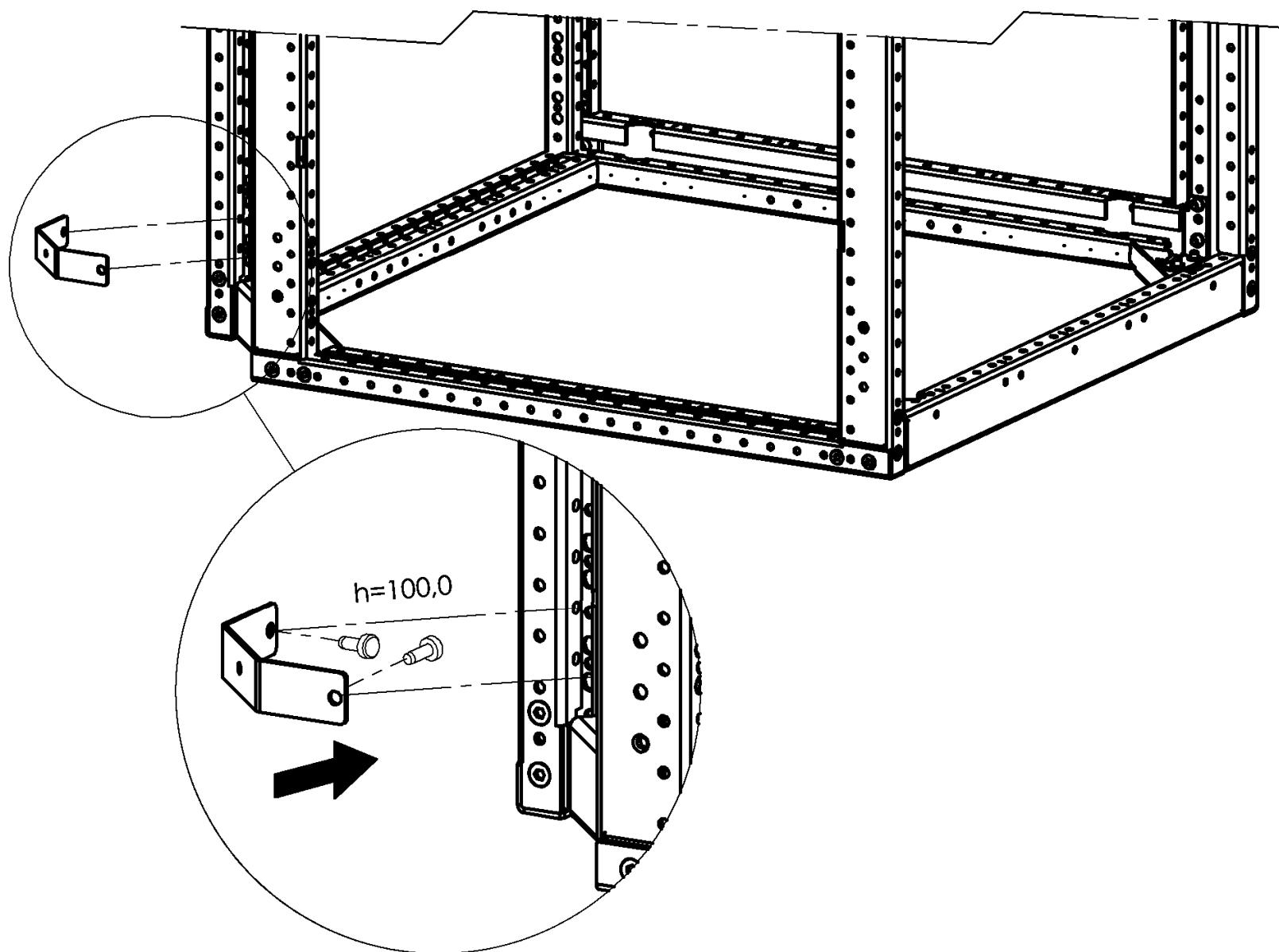
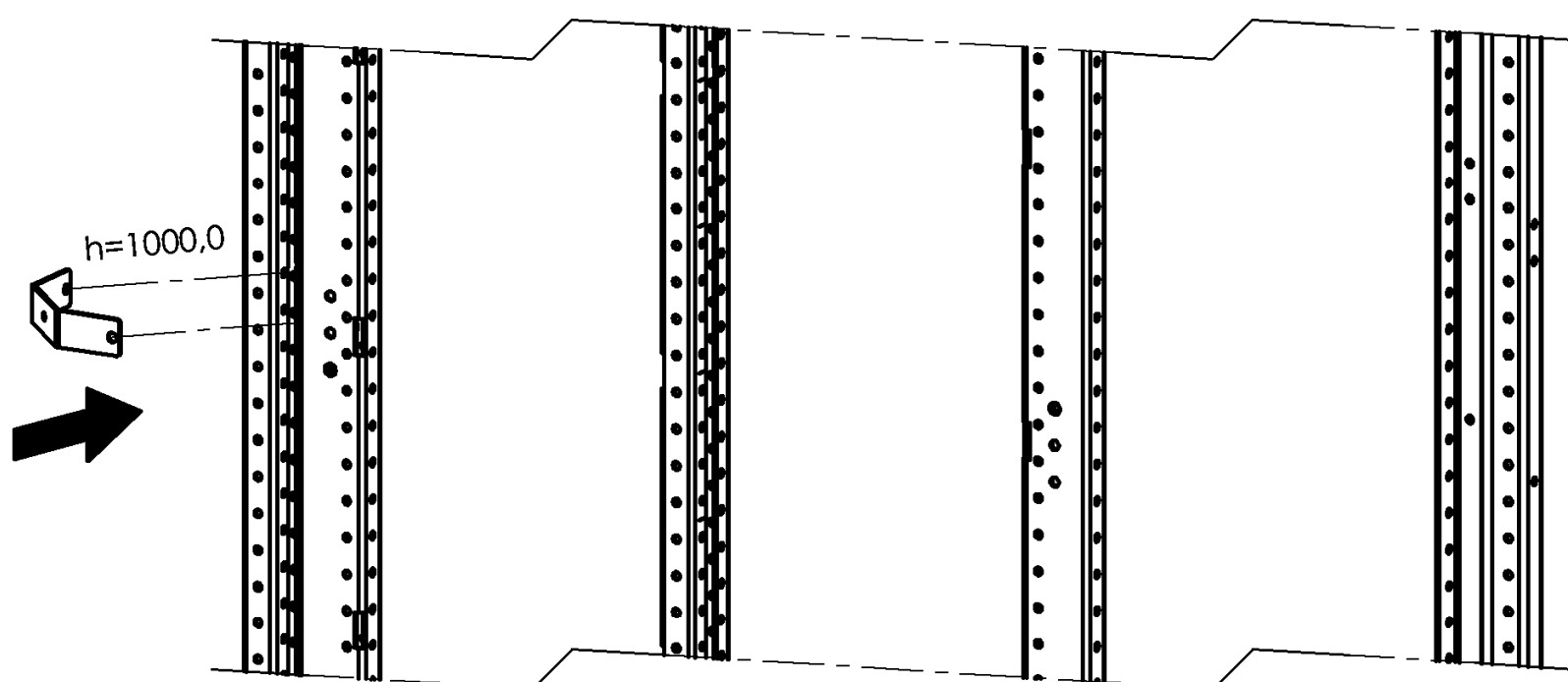
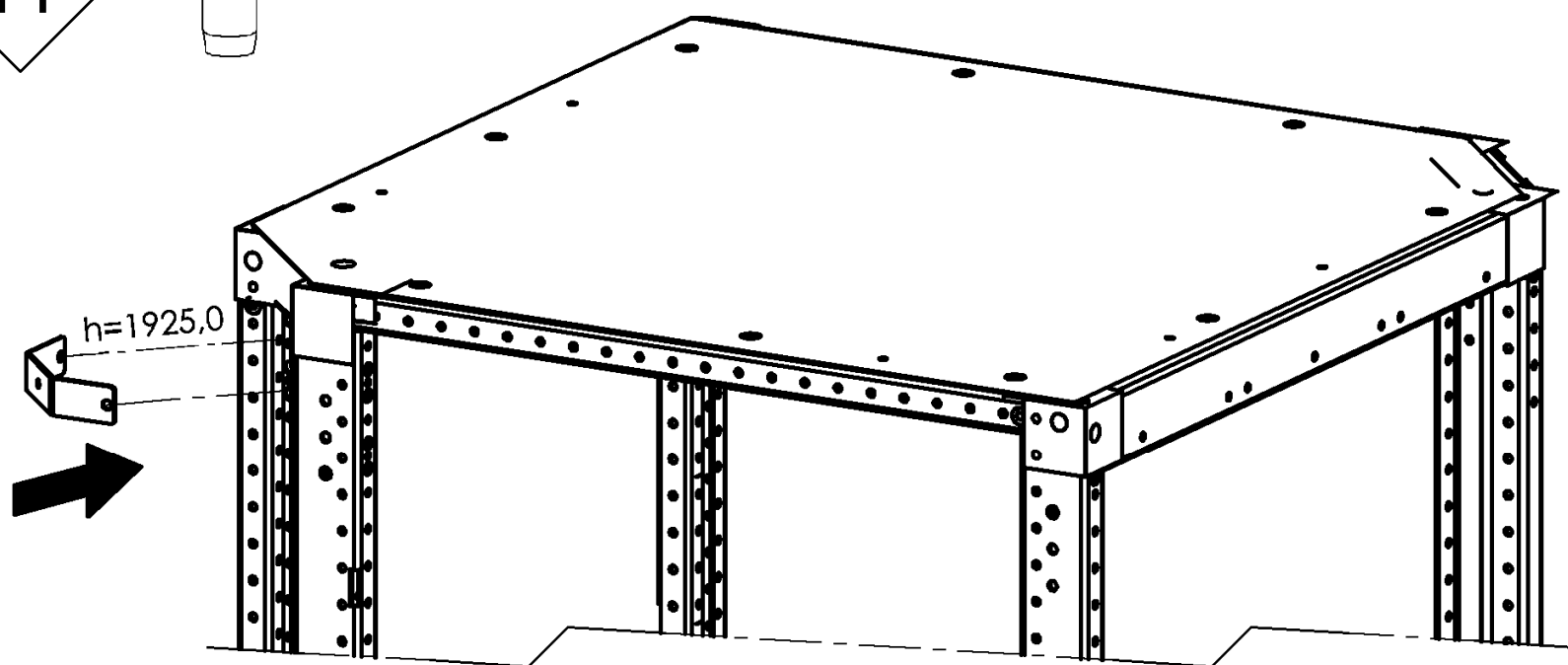

12

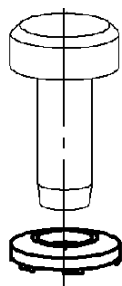

3x M6x12

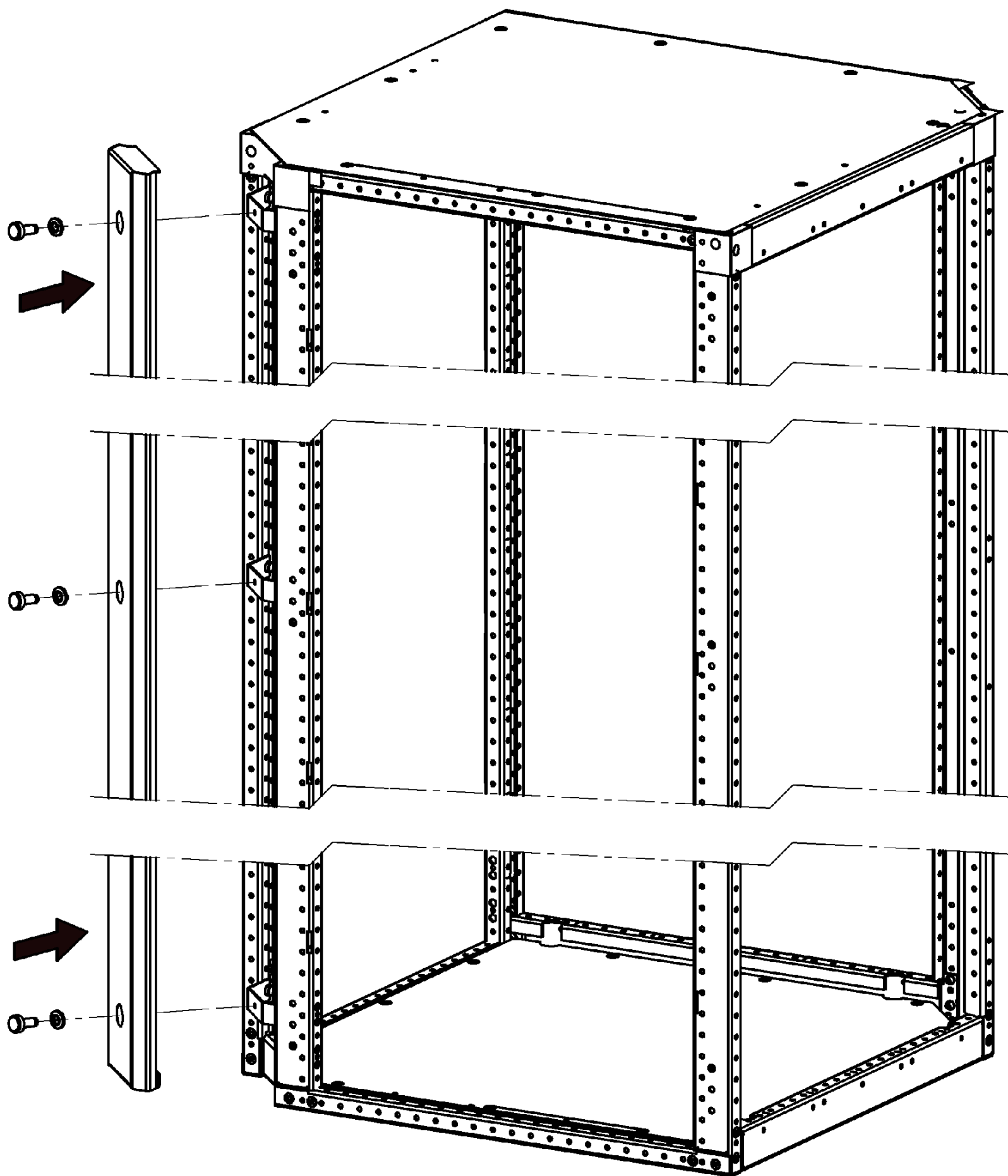



d400

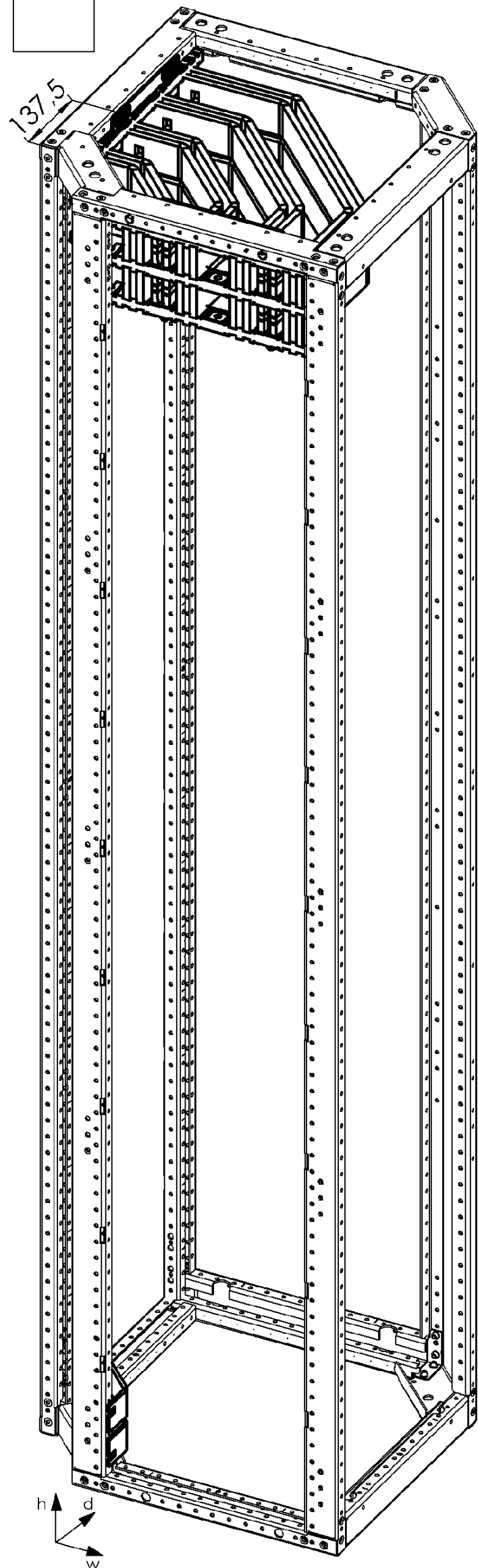
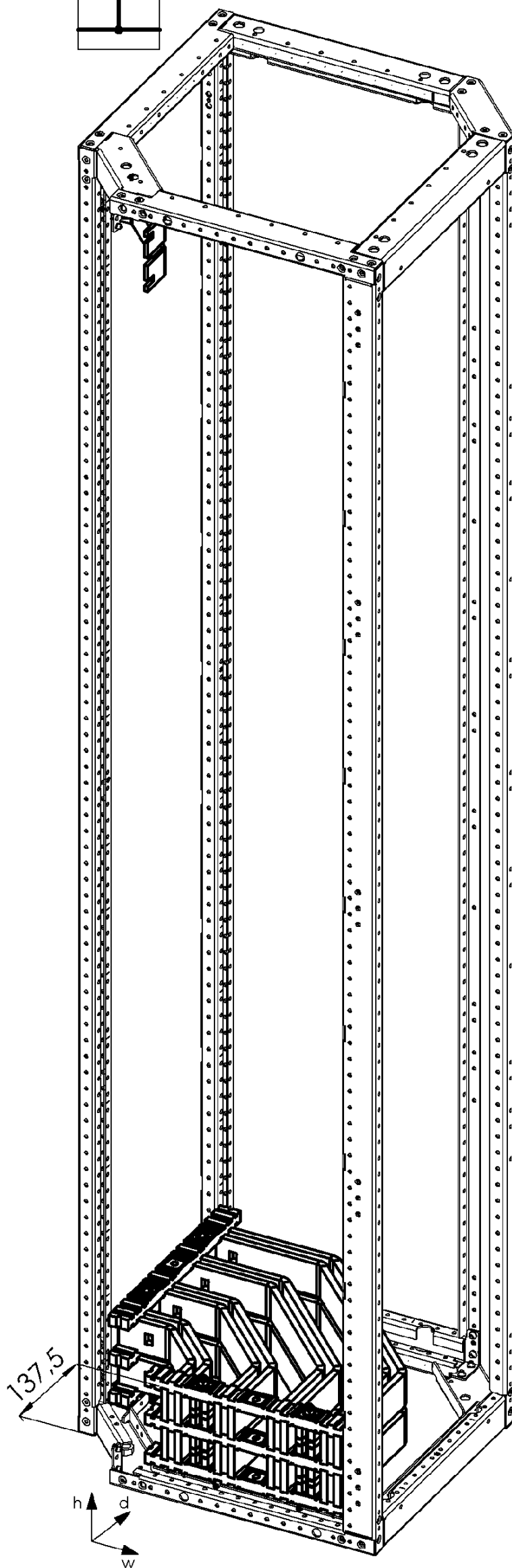
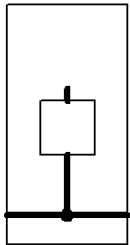
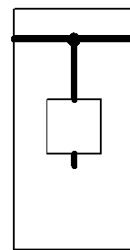



d600 / d800

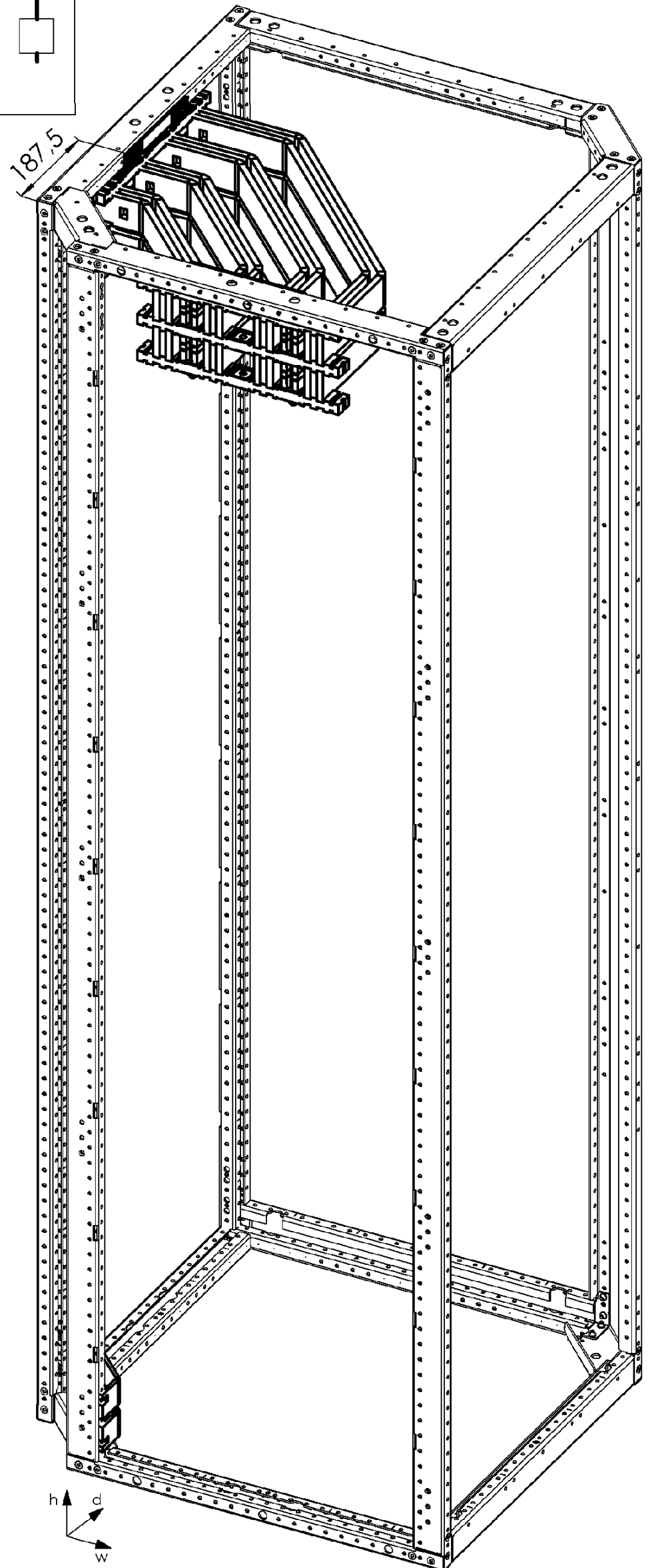
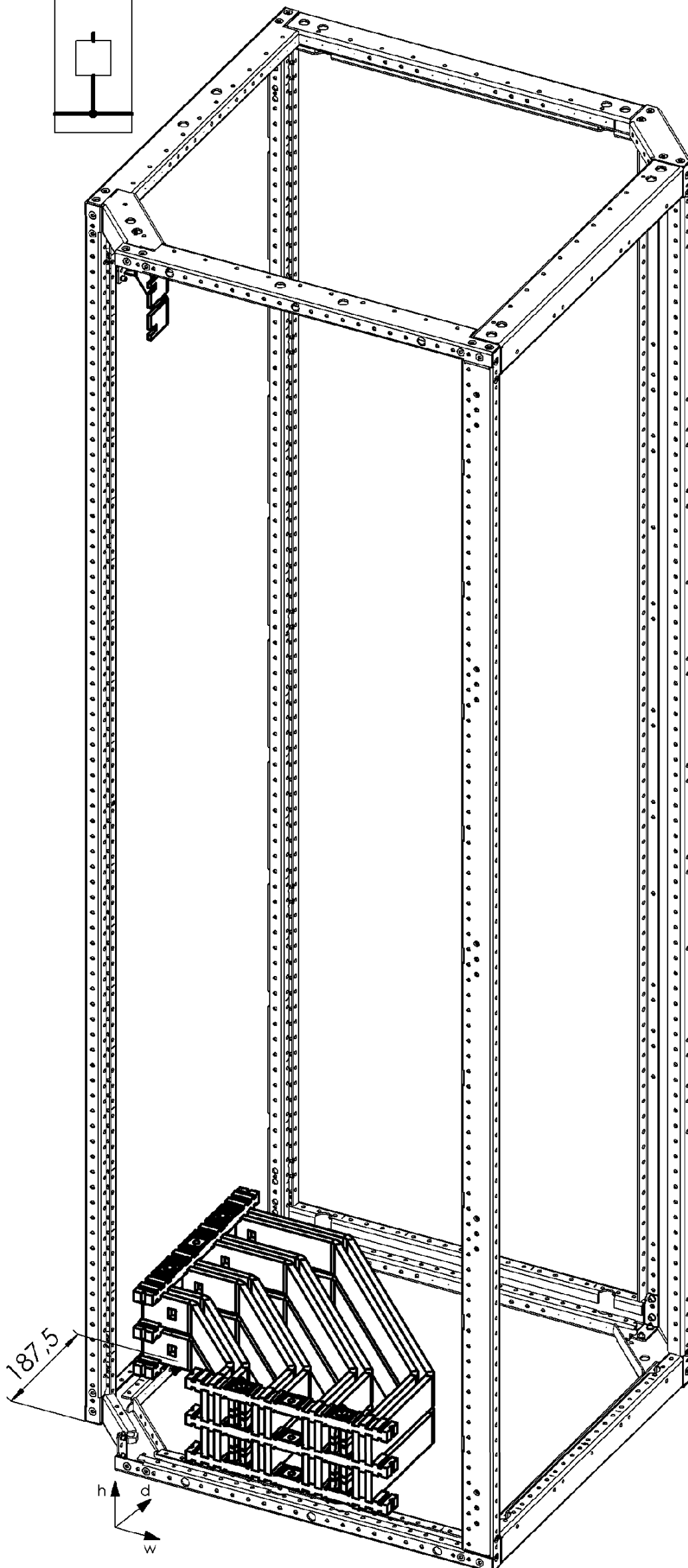
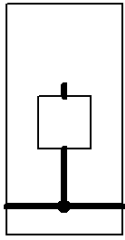
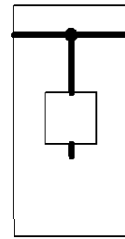

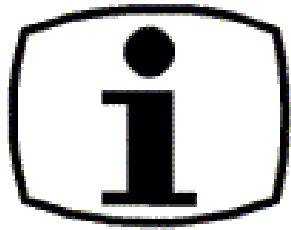

d800

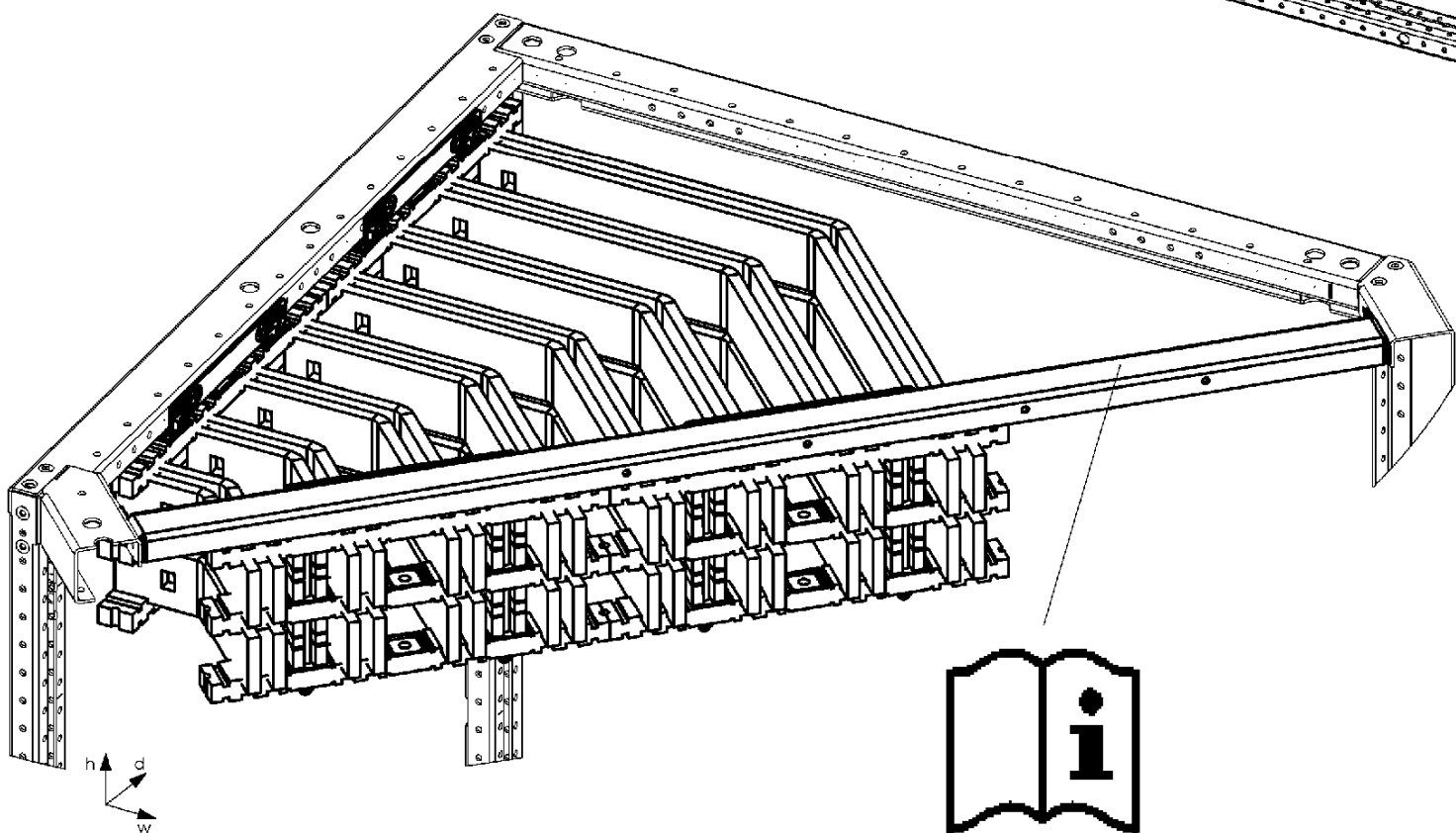
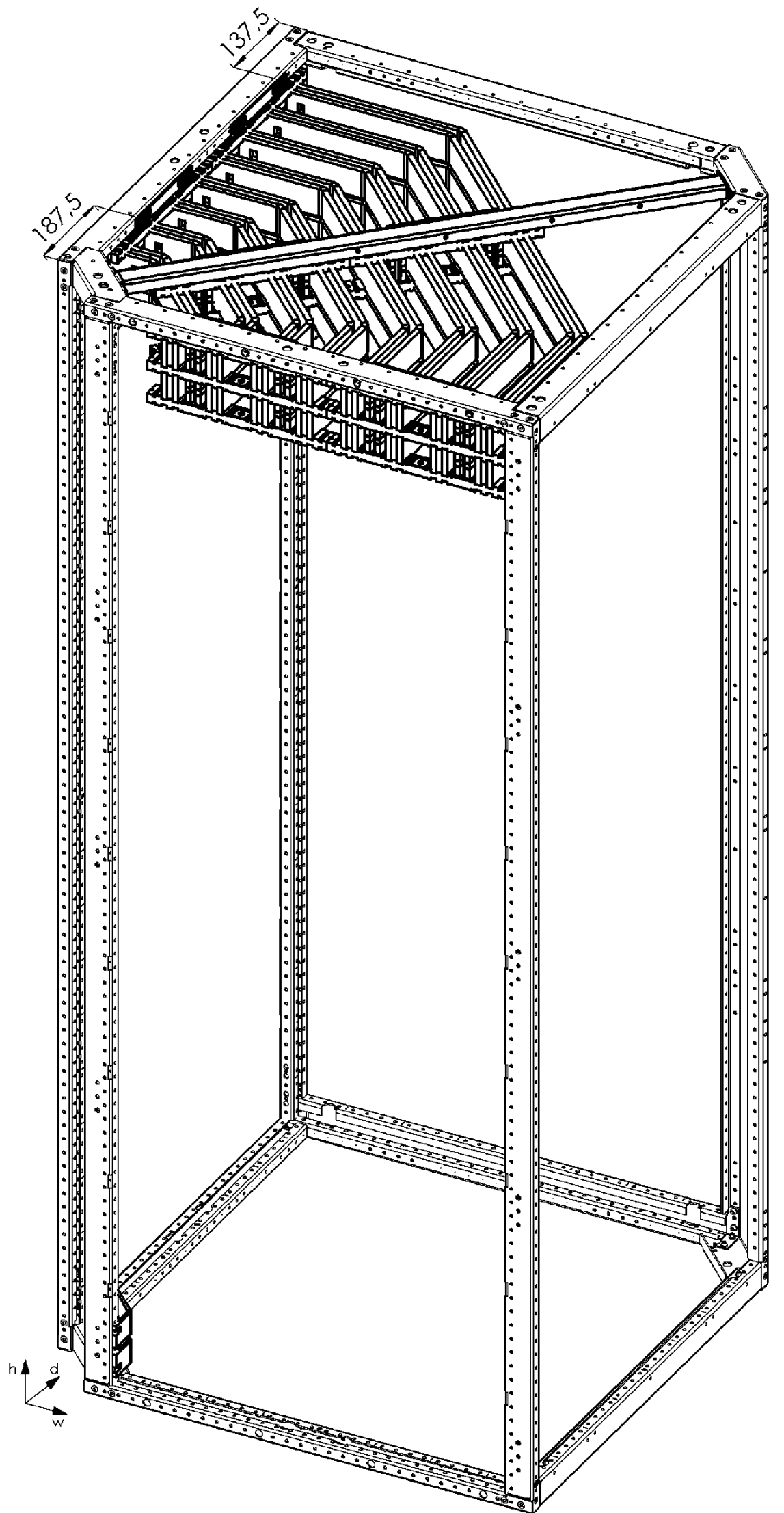
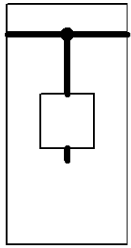

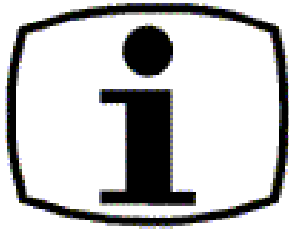

d800

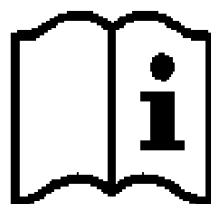
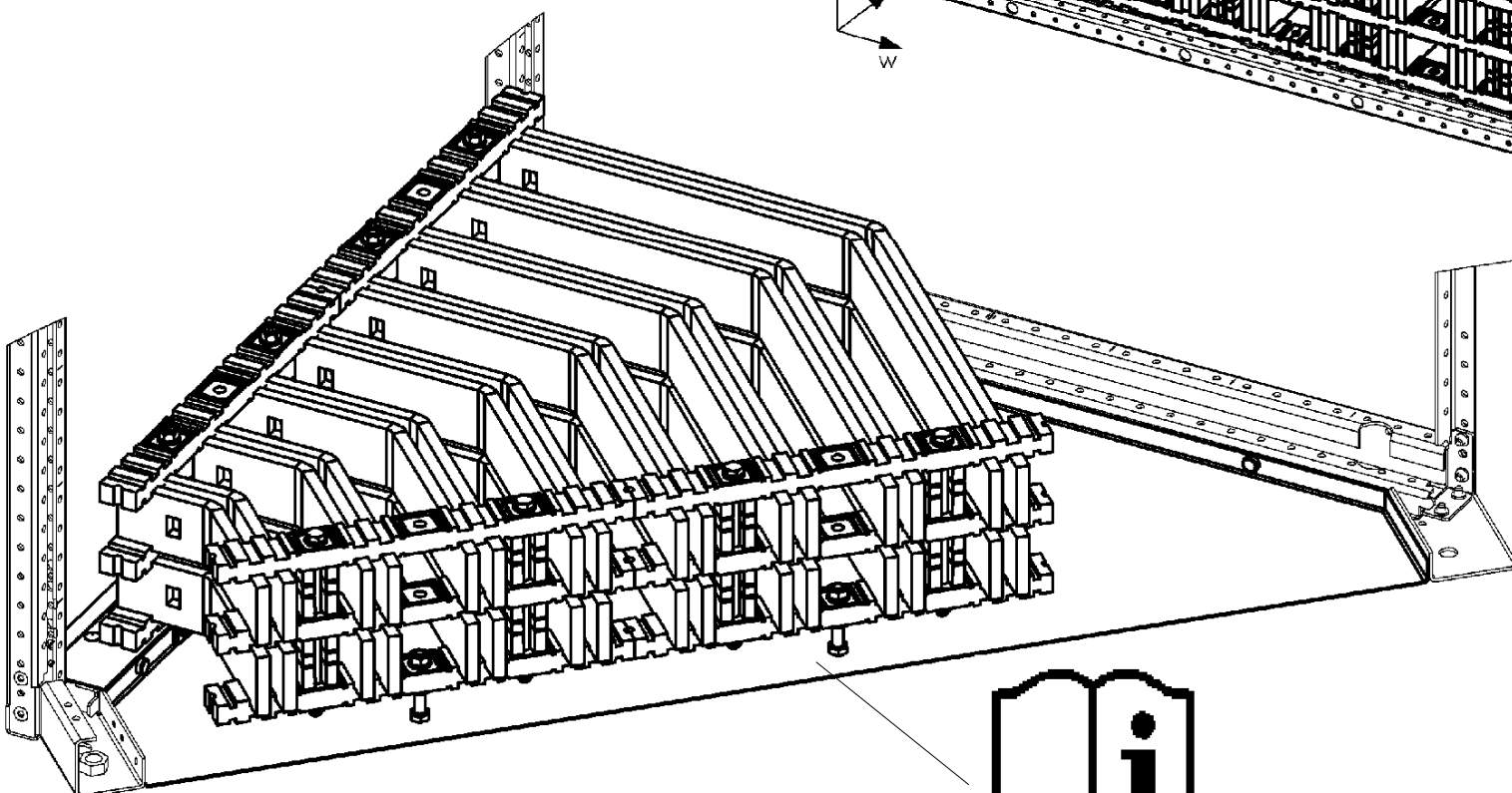
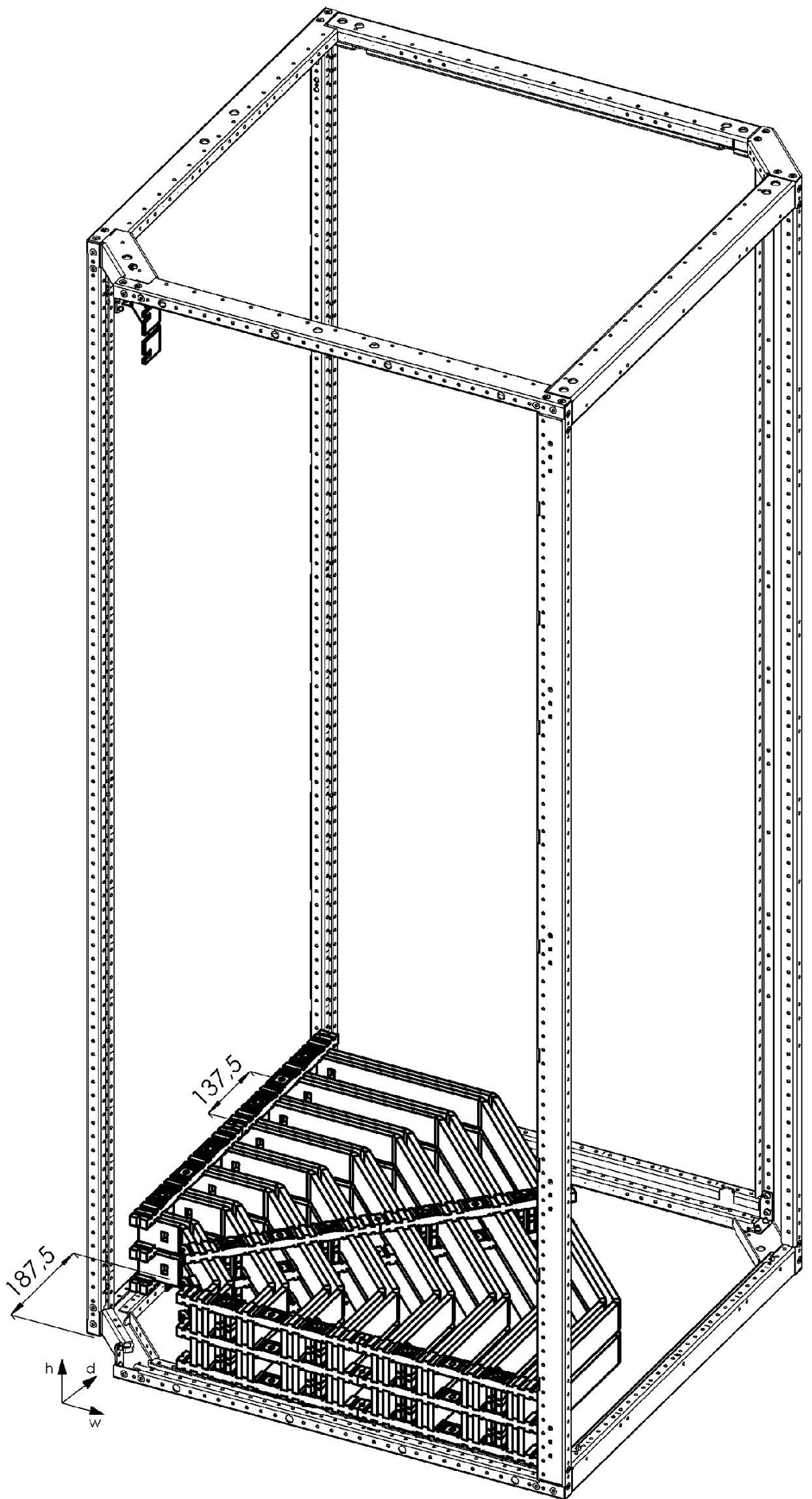
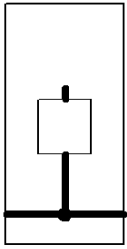



main busbar L, N, PEN

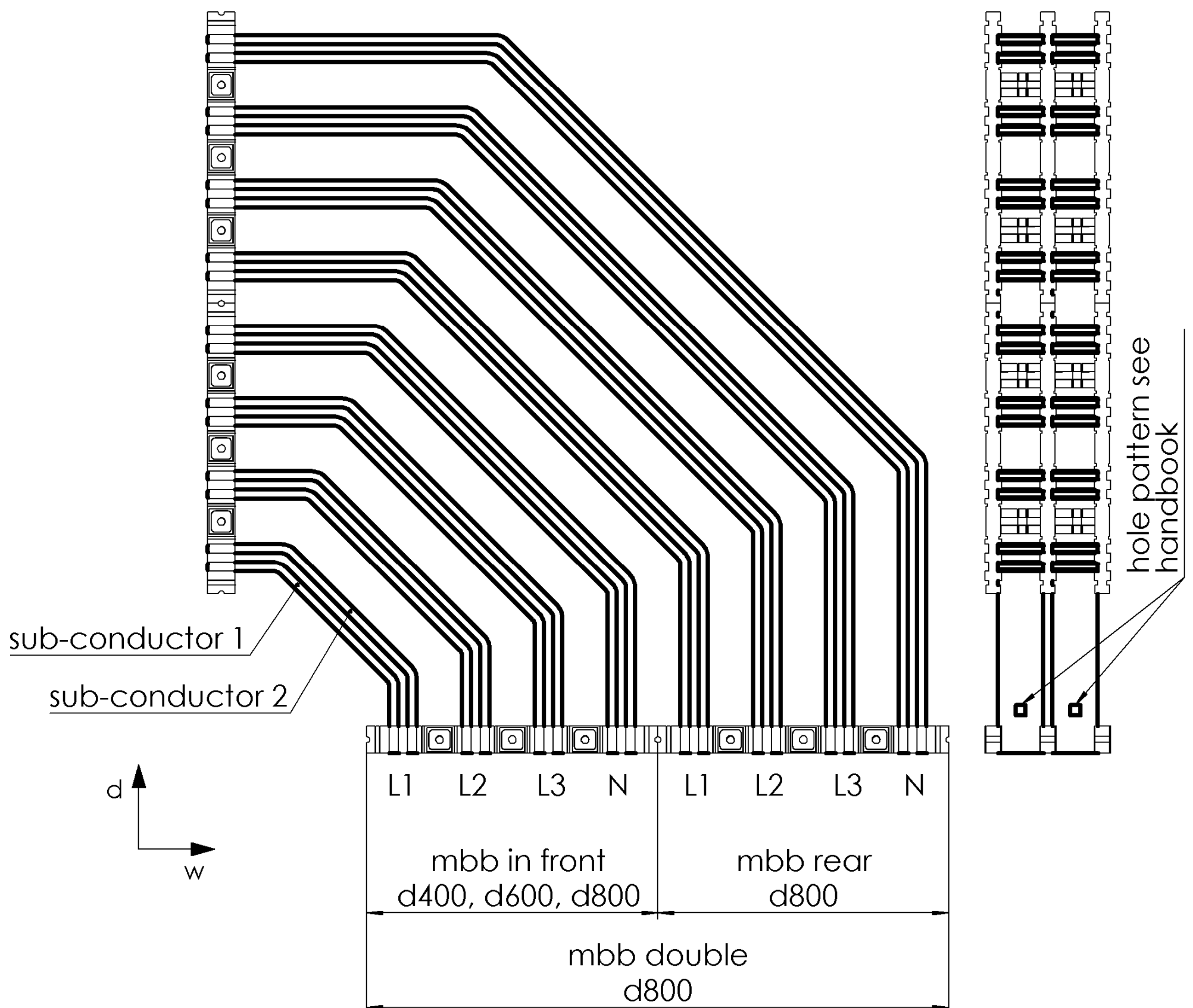
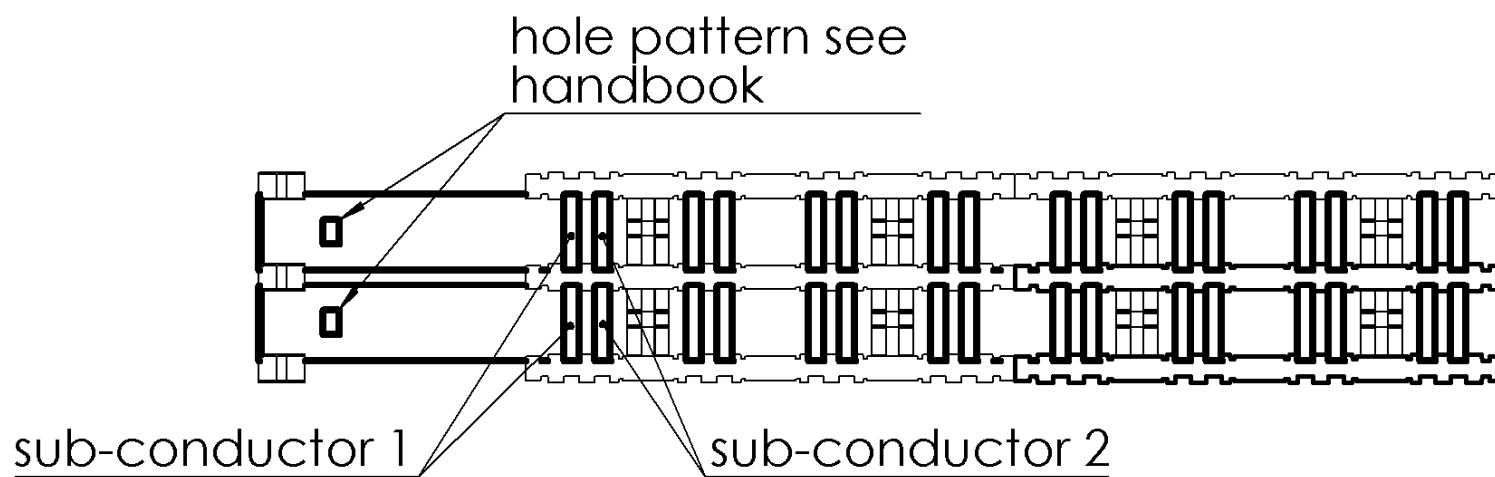



main busbar PE, in front, d400-d800

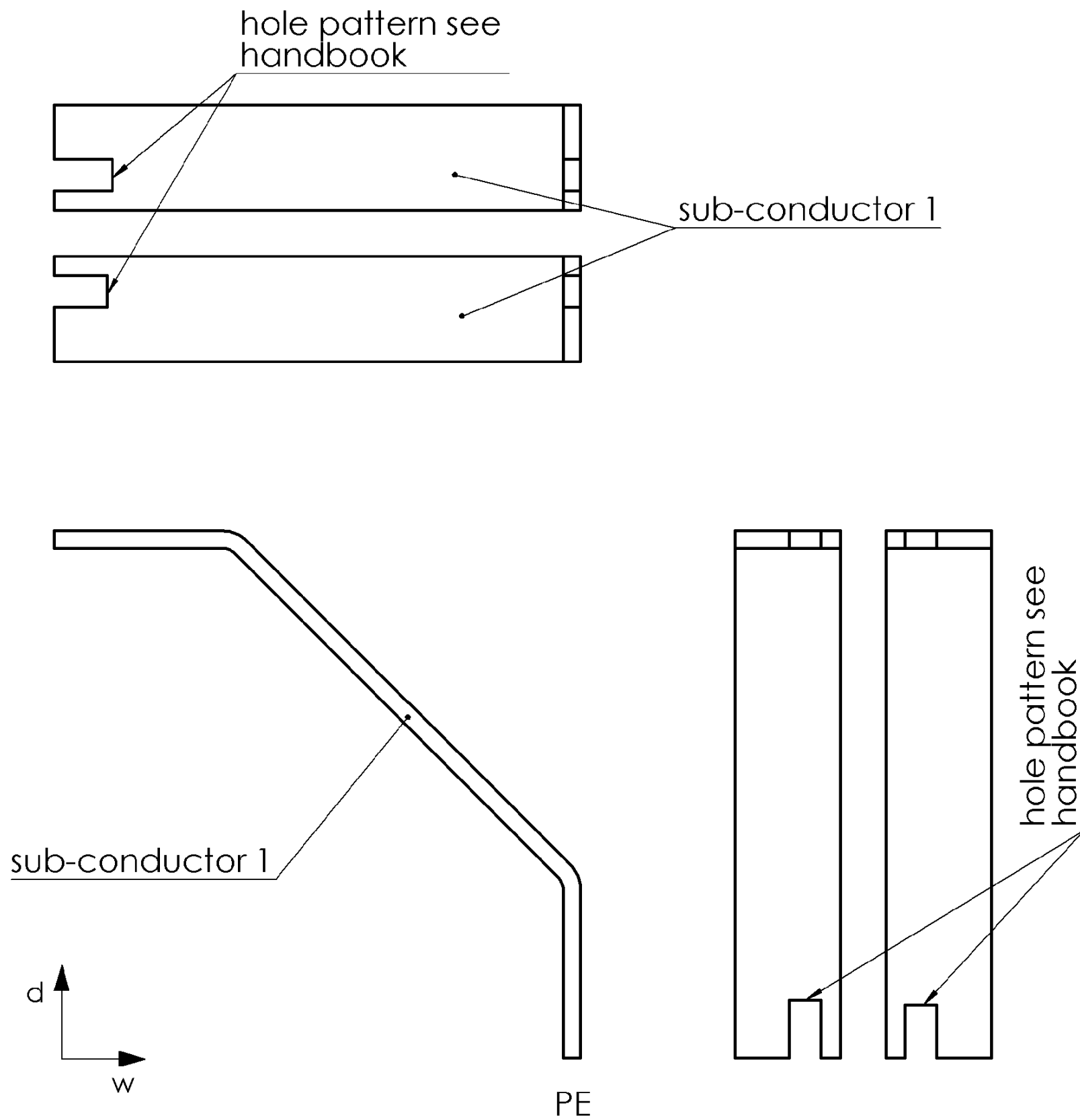



dimension drawing sub-conductor

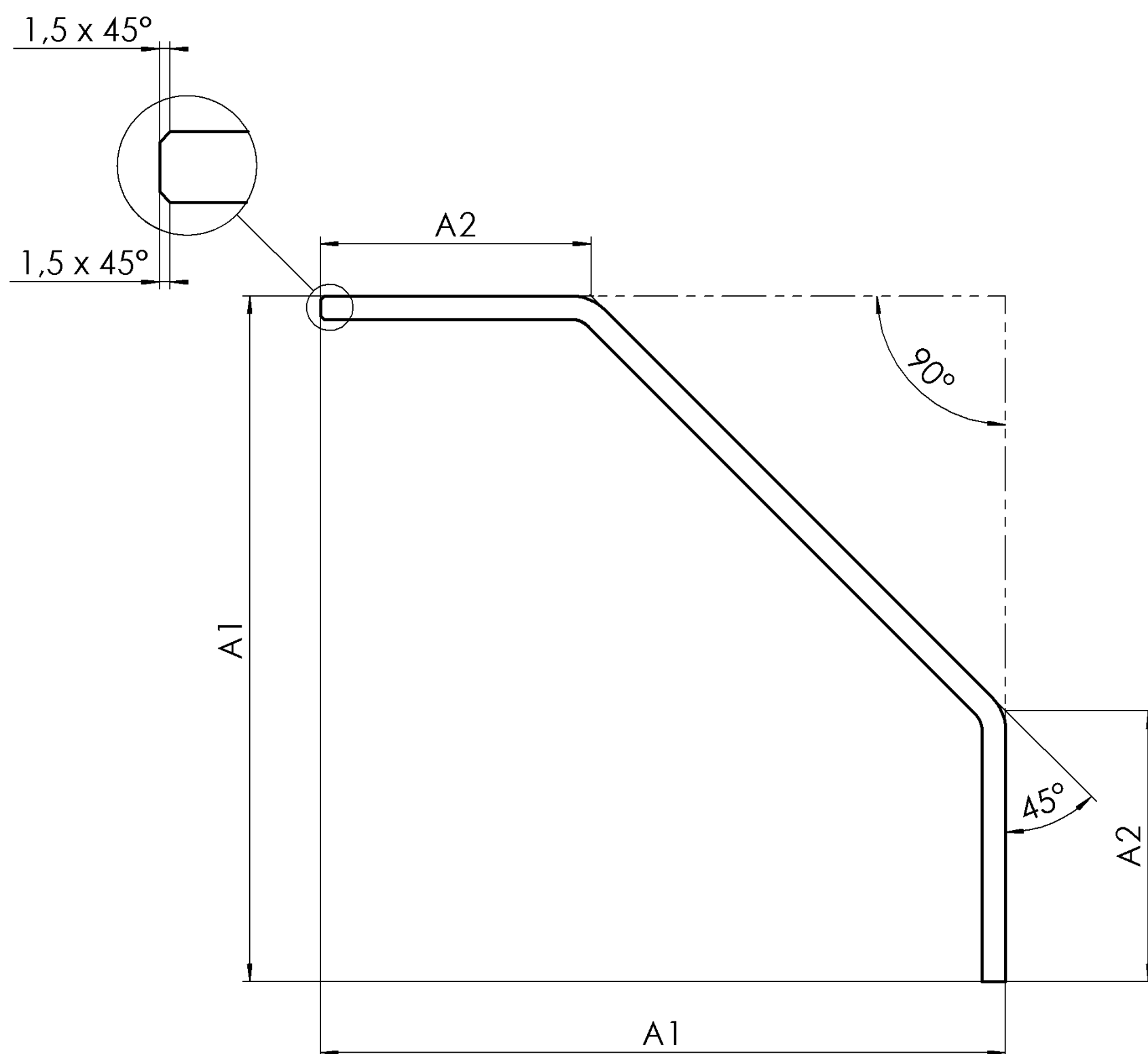



main busbar L, N, PEN								
plant depth d400, mbb top or bottom in front								
main conductor	L1		L2		L3		N	
sub-conductor	1	2	1	2	1	2	1	2
A1	150,0	170,0	230,0	250,0	310,0	330,0	390,0	410,0
A2	81,1	90,1	114,6	123,6	148,1	157,1	181,6	190,6
flat length ¹⁾	270,0	320,0	419,0	455,0	565,0	602,0	710,0	748,0
plant depth d600 / d800, mbb top or bottom in front								
main conductor	L1		L2		L3		N	
sub-conductor	1	2	1	2	1	2	1	2
A1	210,0	230,0	290,0	310,0	370,0	390,0	450,0	470,0
A2	81,1	90,1	114,6	123,6	148,1	157,1	181,6	190,6
flat length ¹⁾	367,0	404,0	513,0	550,0	659,0	695,0	805,0	842,0
plant depth d800, mbb top or bottom rear								
main conductor	L1		L2		L3		N	
sub-conductor	1	2	1	2	1	2	1	2
A1	530,0	550,0	610,0	630,0	690,0	710,0	770,0	790,0
A2	215,1	224,1	248,6	257,6	282,1	291,1	315,6	324,6
flat length ¹⁾	951,0	988,0	1097,0	1134,0	1243,0	1280,0	1389,0	1426,0

main busbar PE		
PE position in front, top or bottom		
main conductor	PE bar 5 thick	PEbar 10 thick
sub-conductor	1	1
A1	150,0	155,0
A2	52,1	54,1
flat length ¹⁾	260,0	264,0

1) calculative length +10% material addition

Technical Assistance: Telephone: +49 (0) 911-895-5900 (8°° - 17°° CET)

Fax: +49 (0) 911-895-5907

E-mail: technical-assistance@siemens.com

Internet: www.siemens.de/lowvoltage/technical-assistance

Technical Support: Telephone: +49 (0) 180 50 50 222