

Female insert - MCC-MT 0,5-1,0 - 1859991

Please be informed that the data shown in this PDF Document is generated from our Online Catalog. Please find the complete data in the user's documentation. Our General Terms of Use for Downloads are valid (<http://phoenixcontact.com/download>)



Female contact, is inserted into the plug after crimping the conductor, for the module plug housing MCC 1...-STZ-3,81 and MCC 1...-STZF-3,81, for cross sections of 0.5 mm² to 1 mm²

Key Commercial Data

Packing unit	1 pc
Minimum order quantity	100 pc
GTIN	 4 017918 127091
GTIN	4017918127091
Weight per Piece (excluding packing)	0.350 g
Custom tariff number	85366990
Country of origin	Germany

Technical data

Item properties

Brief article description	Female insert
Type of contact	Female connector
Range of articles	MCC-MT
Pitch	0 mm

Electrical parameters

Nominal current	8 A
Rated current	8 A

Connection capacity

Connection method	Crimp contact
-------------------	---------------

Female insert - MCC-MT 0,5-1,0 - 1859991

Technical data

Connection capacity

Type of contact	Female connector
Conductor cross section flexible	0.5 mm ² ... 1 mm ²
Conductor cross section AWG / kcmil	20 ... 18
Stripping length	4 mm ... 4.1 mm
Core diameter including insulation	1.4 mm ... 1.8 mm

Material specifications - contact

Contact surface	Tin
Contact surface chemical symbol	Sn

Dimensions for the product

Packaging information

Type of packaging	Bulk goods
Pieces per package	100
Denomination packing units	Pcs.

Environmental Product Compliance

China RoHS	Environmentally friendly use period: unlimited = EFUP-e
	No hazardous substances above threshold values

Drawings

Dimensional drawing

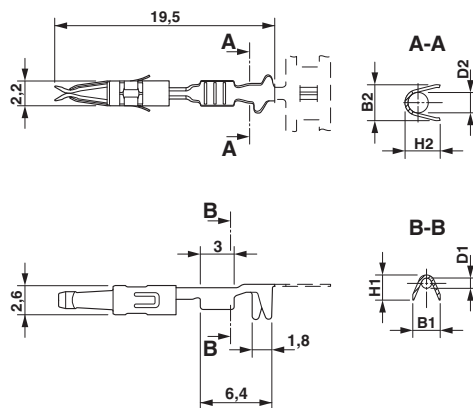

Classifications

eCl@ss

eCl@ss 10.0.1	27440204
---------------	----------

Female insert - MCC-MT 0,5-1,0 - 1859991

Classifications

eCl@ss

eCl@ss 11.0	27460403
eCl@ss 4.0	27260700
eCl@ss 4.1	27260700
eCl@ss 5.0	27260700
eCl@ss 5.1	27261200
eCl@ss 6.0	27261200
eCl@ss 7.0	27440204
eCl@ss 9.0	27440204

ETIM

ETIM 3.0	EC001121
ETIM 4.0	EC000796
ETIM 6.0	EC000796
ETIM 7.0	EC000796

UNSPSC

UNSPSC 6.01	30211810
UNSPSC 7.0901	39121410
UNSPSC 11	39121409
UNSPSC 12.01	39121409
UNSPSC 13.2	39121409
UNSPSC 18.0	39121522
UNSPSC 19.0	39121522
UNSPSC 20.0	39121522
UNSPSC 21.0	39121522

Approvals

Approvals

Approvals

EAC

Ex Approvals

Approval details

Female insert - MCC-MT 0,5-1,0 - 1859991

Approvals

EAC



B.01687

Accessories

Accessories

Mounting material

Crimping pliers - CRIMPFOX-1,6-ER-1,50-GH - 1772793



Crimping pliers, for IBS DSUB.../C