

## I/O module - ILB IB 24 DI16 DO16-DSUB - 2878625

Please be informed that the data shown in this PDF Document is generated from our Online Catalog. Please find the complete data in the user's documentation. Our General Terms of Use for Downloads are valid (<http://phoenixcontact.com/download>)



Inline, Block IO, INTERBUS, D-SUB-9 female/D-SUB-9 male, Digital inputs: 16, 24 V DC, connection method: 3-wire, Digital outputs: 16, 24 V DC, 500 mA, connection method: 3-wire, degree of protection: IP20, including Inline connector

### Your advantages

- ✓ 16 digital inputs
- ✓ Connection of sensors in 2 and 3-wire technology
- ✓ Maximum permissible load current per sensor: 125 mA
- ✓ Maximum permissible load current from the terminal: 2 A
- ✓ 16 digital outputs
- ✓ Connection of actuators in 2 and 3-wire technology
- ✓ Nominal current per output: 500 mA
- ✓ Total current of the terminal: 8 A
- ✓ Short-circuit-proof and overload-protected outputs
- ✓ Diagnostic and status indicators



### Key Commercial Data

Packing unit	1 pc
GTIN	 4 046356 048590
GTIN	4046356048590
Weight per Piece (excluding packing)	492.300 g
Custom tariff number	85389091
Country of origin	Germany

### Technical data

#### Note

# I/O module - ILB IB 24 DI16 DO16-DSUB - 2878625

## Technical data

### Note

Utilization restriction	EMC: class A product, see manufacturer's declaration in the download area
-------------------------	---

### Dimensions

Width	156 mm
Height	141 mm
Depth	57 mm
Note on dimensions	Specifications with connectors

### Ambient conditions

Ambient temperature (operation)	-25 °C ... 60 °C
Ambient temperature (storage/transport)	-25 °C ... 85 °C
Permissible humidity (operation)	max. 85 % (non-condensing)
Permissible humidity (storage/transport)	95 % (non-condensing)
Air pressure (operation)	80 kPa ... 108 kPa (up to 2000 m above sea level)
Air pressure (storage/transport)	66 kPa ... 108 kPa (up to 3500 m above sea level)
Degree of protection	IP20

### General

Mounting type	DIN rail
Color	green
Net weight	440 g
Note on weight specifications	with connectors
Mounting type	NS 35/7,5

### Interfaces

Designation	INTERBUS
Connection method	D-SUB-9 female/D-SUB-9 male
Transmission speed	500 kbps

### Digital inputs

Input name	Digital inputs
Description of the input	EN 61131-2 type 1
Connection method	Spring-cage connection
Connection technology	3-wire
Number of inputs	16
Typical response time	approx. 500 µs
Protective circuit	Short-circuit protection, overload protection of the sensor supply
Nominal input voltage $U_{IN}$	24 V DC

### Digital outputs

## I/O module - ILB IB 24 DI16 DO16-DSUB - 2878625

### Technical data

#### Digital outputs

Output name	Digital outputs
Connection method	Spring-cage connection
Connection technology	3-wire
Number of outputs	16
Protective circuit	Short-circuit and overload protection
Output voltage	24 V DC
Nominal output voltage	24 V DC
Maximum output current per channel	500 mA

#### Standards and Regulations

Noise emission	Class B (residential)
Mechanical tests	Vibration resistance in acc. with EN 60068-2-6/IEC 60068-2-6 5g
	Vibration resistance in acc. with EN 60068-2-6/IEC 60068-2-6 25g
	Shock in acc. with EN 60068-2-27/IEC 60068-2-27 25g
Protection class	III (IEC 61140, EN 61140, VDE 0140-1)

#### Environmental Product Compliance

REACH SVHC	Lead 7439-92-1
China RoHS	Environmentally Friendly Use Period = 50 years
	For details about hazardous substances go to tab "Downloads", Category "Manufacturer's declaration"

### Drawings

# I/O module - ILB IB 24 DI16 DO16-DSUB - 2878625

Connection diagram

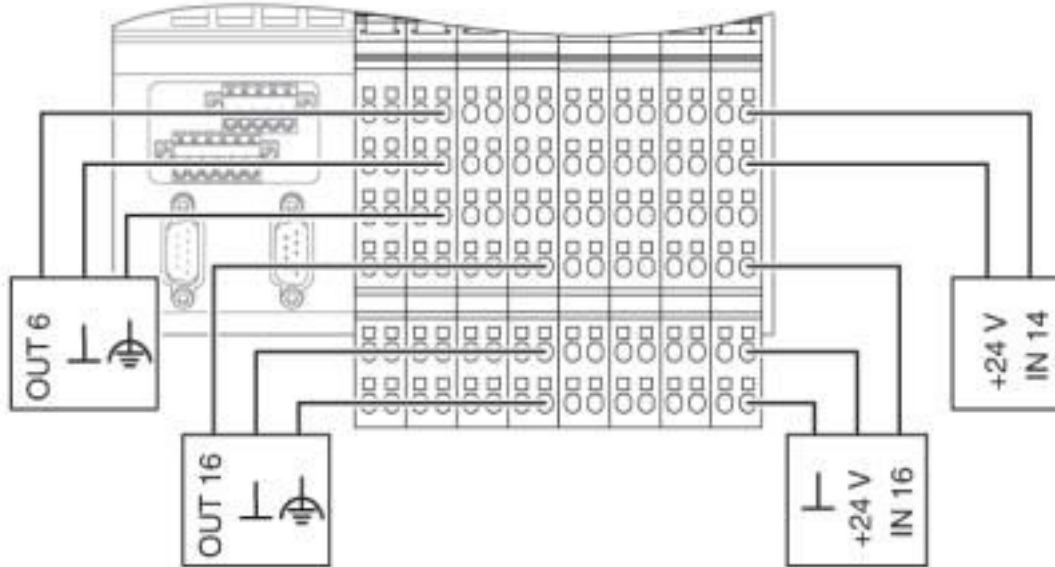

Dimensional drawing

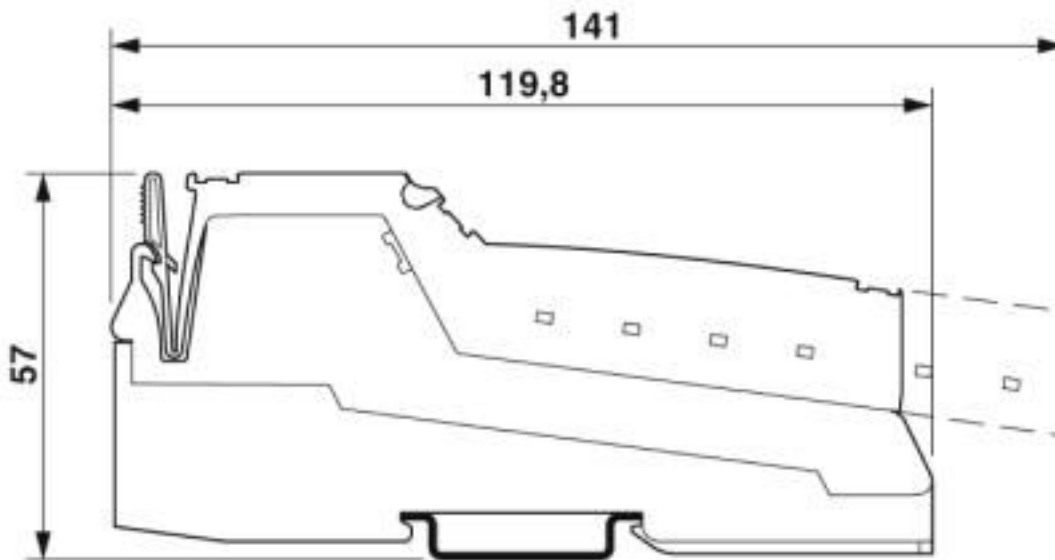

## Classifications

eCl@ss

eCl@ss 10.0.1	27242604
eCl@ss 4.0	27250300
eCl@ss 4.1	27250300

# I/O module - ILB IB 24 DI16 DO16-DSUB - 2878625

## Classifications

### eCl@ss

eCl@ss 5.0	27250300
eCl@ss 5.1	27242600
eCl@ss 6.0	27242600
eCl@ss 7.0	27242604
eCl@ss 8.0	27242604
eCl@ss 9.0	27242604

### ETIM

ETIM 2.0	EC001430
ETIM 3.0	EC001599
ETIM 4.0	EC001599
ETIM 5.0	EC001599
ETIM 6.0	EC001599
ETIM 7.0	EC001599

### UNSPSC

UNSPSC 6.01	43172015
UNSPSC 7.0901	43201404
UNSPSC 11	43172015
UNSPSC 12.01	43201404
UNSPSC 13.2	32151602
UNSPSC 18.0	32151602
UNSPSC 19.0	32151602
UNSPSC 20.0	32151602
UNSPSC 21.0	32151602

## Approvals

### Approvals

---

Approvals

INTERBUS CLUB

---

Ex Approvals

---

### Approval details

## I/O module - ILB IB 24 DI16 DO16-DSUB - 2878625

### Approvals

INTERBUS CLUB

454/02.12.05

### Accessories

#### Accessories

##### End block

End clamp - CLIPFIX 35-5 - 3022276



Quick mounting end clamp for NS 35/7,5 DIN rail or NS 35/15 DIN rail, with marking option, with parking option for FBS...5, FBS...6, KSS 5, KSS 6, width: 5.15 mm, color: gray

##### Labeling panel

Labeling field - IB IL FIELD 2 - 2727501

Labeling field, width: 12.2 mm



##### Terminal marking

Insert strip - ESL 62X10 - 0809492



Insert strip, Sheet, white, unlabeled, can be labeled with: Office printing systems: Laser printer, mounting type: insert, lettering field size: 62 x 10 mm, Number of individual labels: 72

Flat zack marker sheet - ZBFM 6/WH:UNBEDRUCKT - 0803618



Flat zack marker sheet, Sheet, white, unlabeled, can be labeled with: CMS-P1-PLOTTER, PLOTMARK, mounting type: snap into flat marker groove, for terminal block width: 6.2 mm, lettering field size: 5 x 5.5 mm, Number of individual labels: 100

## I/O module - ILB IB 24 DI16 DO16-DSUB - 2878625

### Accessories

#### Spare parts

Printed-circuit board connector - FK-MCP 1,5/ 5-STF-3,81 - 1851261



PCB connector, nominal current: 8 A, rated voltage (III/2): 160 V, nominal cross section: 1.5 mm<sup>2</sup>, number of positions: 5, pitch: 3.81 mm, connection method: Push-in spring connection, color: green, contact surface: Tin

Printed-circuit board connector - FK-MCP 1,5/ 6-STF-3,81 - 1851274



PCB connector, nominal current: 8 A, rated voltage (III/2): 160 V, nominal cross section: 1.5 mm<sup>2</sup>, number of positions: 6, pitch: 3.81 mm, connection method: Push-in spring connection, color: green, contact surface: Tin

Inline connector - IB IL SCN-12-ICP - 2727611



Connector, color coded, for digital 4, or 16-channel Inline input terminals

Inline connector - IB IL SCN-12-OCP - 2727624



Connector, colored identification, for digital 4, or 16-channel Inline output terminal blocks

Printed-circuit board connector - FK-MCP 1,5/ 4-STF-3,81 - 1851258



PCB connector, nominal current: 8 A, rated voltage (III/2): 160 V, nominal cross section: 1.5 mm<sup>2</sup>, number of positions: 4, pitch: 3.81 mm, connection method: Push-in spring connection, color: green, contact surface: Tin

