

Panel mounting frames - VS-08-A-RJ45/LP-2-IP 20 - 1688654

Please be informed that the data shown in this PDF Document is generated from our Online Catalog. Please find the complete data in the user's documentation. Our General Terms of Use for Downloads are valid (<http://phoenixcontact.com/download>)



RJ45 panel mounting frame, 2x, IP20, for socket inserts for PCB connection, without mounting screws



Key Commercial Data

Packing unit	1 pc
Minimum order quantity	5 pc
GTIN	 4 017918 819422
GTIN	4017918819422
Weight per Piece (excluding packing)	1.460 g
Custom tariff number	85389099
Country of origin	Germany

Technical data

Mechanical characteristics

Number of slots	2
Weight	1.46 g
Flammability rating according to UL 94	V0

Ambient conditions

Ambient temperature (operation)	-40 °C ... 80 °C
---------------------------------	------------------

Material data

Housing material	PA
Width	32 mm
Height	26.5 mm

Panel mounting frames - VS-08-A-RJ45/LP-2-IP 20 - 1688654

Technical data

Material data

Depth	3.6 mm
-------	--------

Standards and Regulations

Flammability rating according to UL 94	V0
--	----

Environmental Product Compliance

China RoHS	Environmentally friendly use period: unlimited = EFUP-e
	No hazardous substances above threshold values

Drawings

Panel mounting frames - VS-08-A-RJ45/LP-2-IP 20 - 1688654

Dimensional drawing

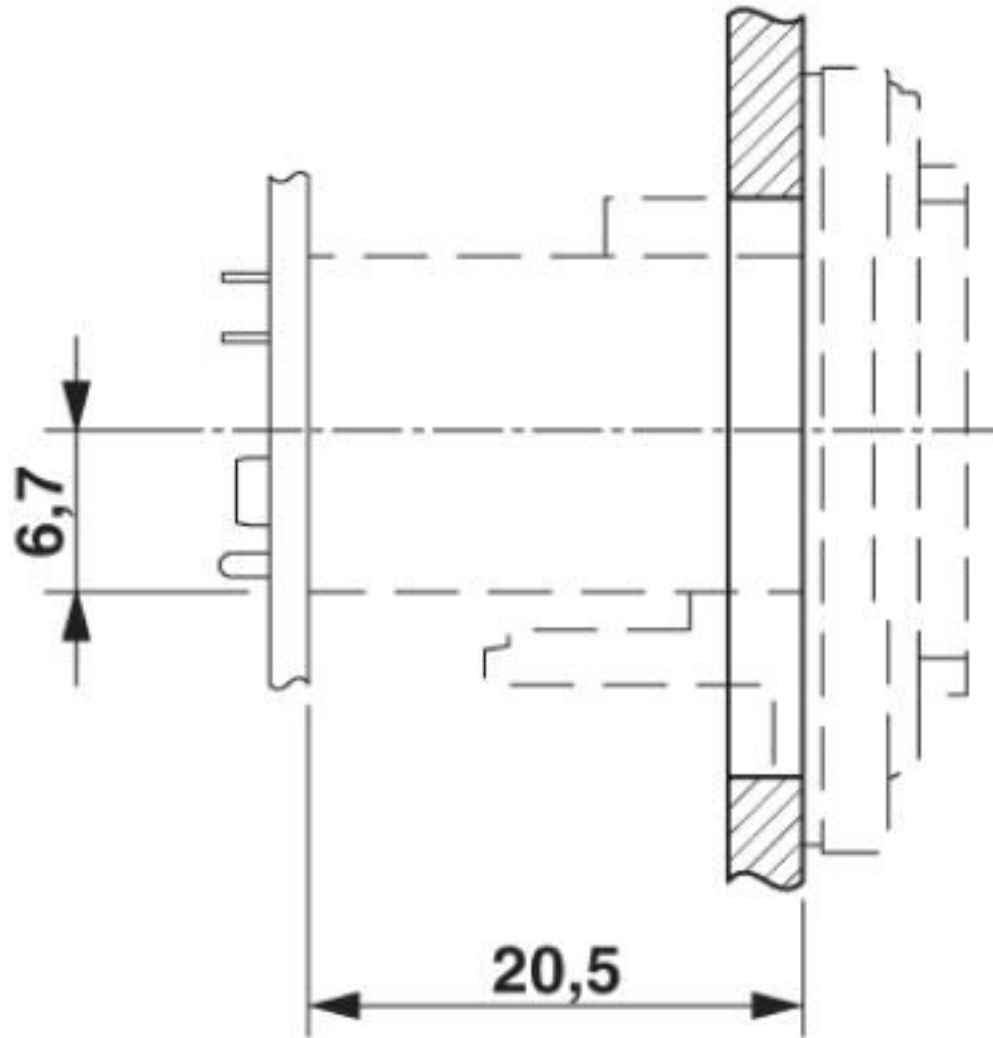

Panel mounting frames - VS-08-A-RJ45/LP-2-IP 20 - 1688654

Dimensional drawing

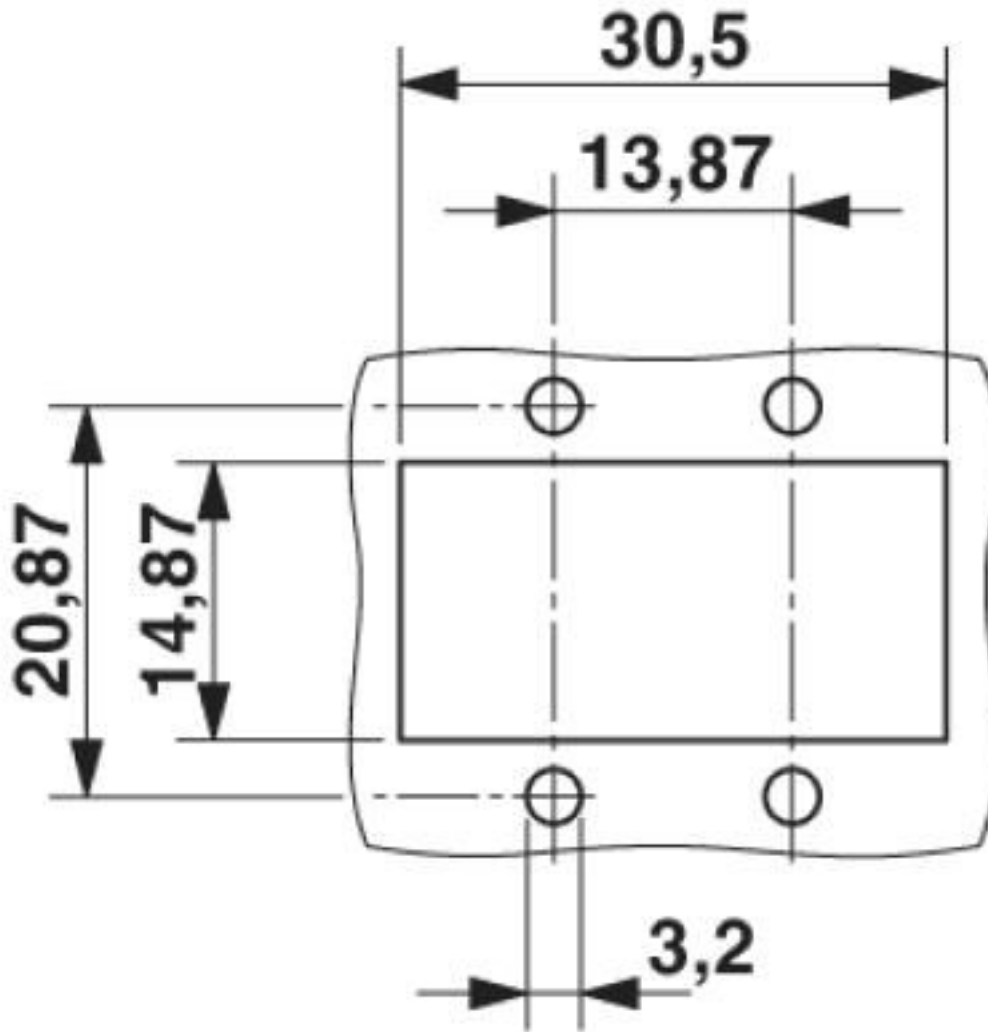

Mounting cutout

Panel mounting frames - VS-08-A-RJ45/LP-2-IP 20 - 1688654

Dimensional drawing

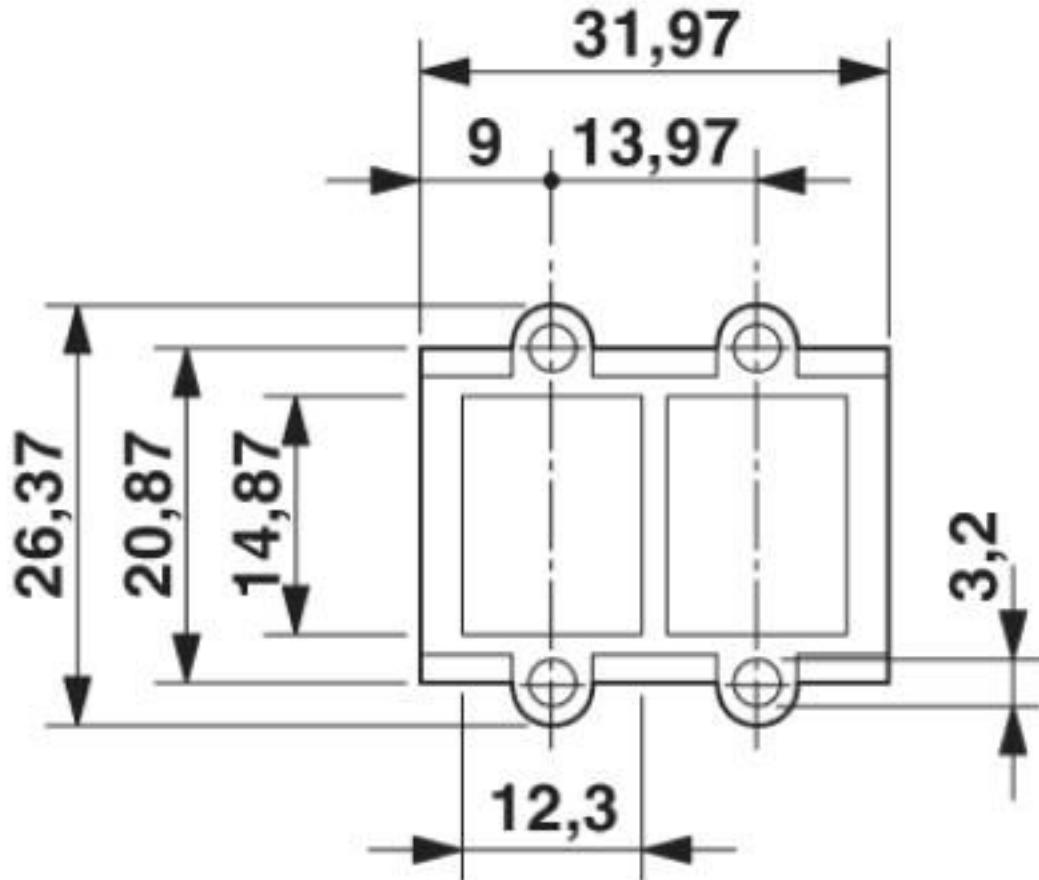

RJ45 panel mounting frame, IP20

Classifications

eCl@ss

eCl@ss 10.0.1	27440210
eCl@ss 4.0	27260700
eCl@ss 4.1	27260700
eCl@ss 5.0	27260700
eCl@ss 5.1	27260700
eCl@ss 6.0	27261200
eCl@ss 7.0	27440210
eCl@ss 8.0	27440210
eCl@ss 9.0	27440210

Panel mounting frames - VS-08-A-RJ45/LP-2-IP 20 - 1688654

Classifications

ETIM

ETIM 2.0	EC000764
ETIM 3.0	EC001121
ETIM 4.0	EC002310
ETIM 5.0	EC002310
ETIM 6.0	EC002310
ETIM 7.0	EC002310

UNSPSC

UNSPSC 6.01	31261501
UNSPSC 7.0901	31261501
UNSPSC 11	31261501
UNSPSC 12.01	31261501
UNSPSC 13.2	39121421
UNSPSC 18.0	39121421
UNSPSC 19.0	39121421
UNSPSC 20.0	39121421
UNSPSC 21.0	39121421

Accessories

Accessories

Female insert

RJ45 PCB connectors - VS-08-BU-RJ45/LP-2 - 1688599



RJ45 socket insert, 2x, for PCB assembly, CAT5e, 8-pos., shielded, with angled solder pins