

Cable lug - HC-M-MHR-PE16 - 1636981

Please be informed that the data shown in this PDF Document is generated from our Online Catalog. Please find the complete data in the user's documentation. Our General Terms of Use for Downloads are valid (<http://phoenixcontact.com/download>)



Cable lug for HEAVYCON-MODULAR; PE connection extension to 16 mm², for crimping with crimp pliers



COMPLETE

Key Commercial Data

Packing unit	1 pc
GTIN	 4 046356 088985
GTIN	4046356088985
Weight per Piece (excluding packing)	5.100 g
Custom tariff number	85369010
Country of origin	Germany

Technical data

General

Material	Brass, nickel-plated
Assembly instructions	Crimping with crimping pliers for non-insulated cable connections according to DIN 46230 (crimping area 16 mm ²), e.g., Klauke type K25

Environmental Product Compliance

China RoHS	Environmentally friendly use period: unlimited = EFUP-e
	No hazardous substances above threshold values

Drawings

Cable lug - HC-M-MHR-PE16 - 1636981

Dimensional drawing

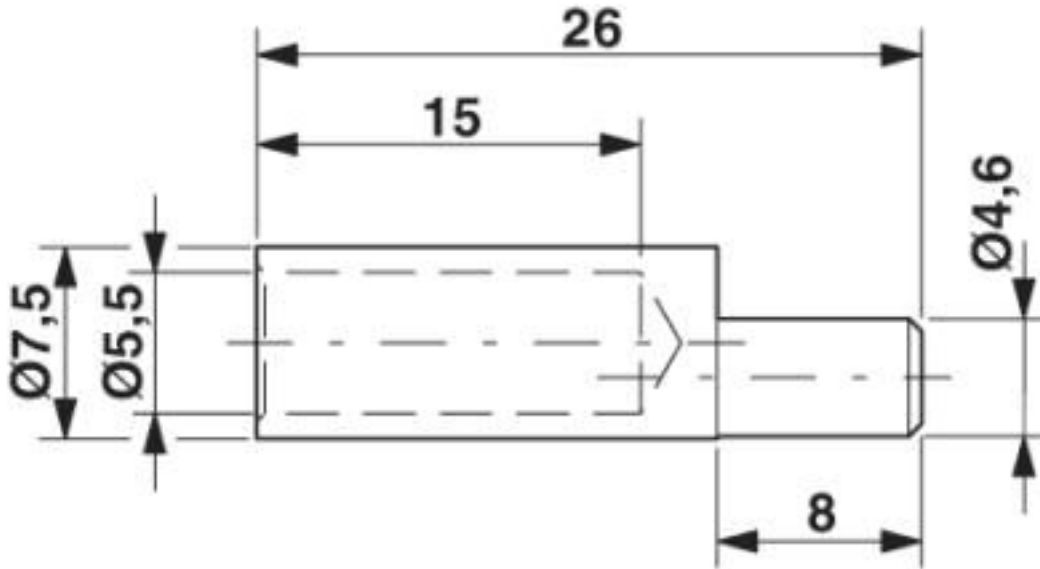

Dimensional drawing

Classifications

eCl@ss

eCl@ss 10.0.1	27440192
eCl@ss 4.0	27260700
eCl@ss 4.1	27260700
eCl@ss 5.0	27400200
eCl@ss 5.1	27400200
eCl@ss 6.0	27400200
eCl@ss 7.0	27400216
eCl@ss 8.0	27400216
eCl@ss 9.0	27440192

ETIM

ETIM 3.0	EC001048
ETIM 4.0	EC001048
ETIM 5.0	EC001048
ETIM 6.0	EC001048
ETIM 7.0	EC001048

Cable lug - HC-M-MHR-PE16 - 1636981

Classifications

UNSPSC

UNSPSC 6.01	30211923
UNSPSC 7.0901	39121522
UNSPSC 11	39121522
UNSPSC 12.01	39121522
UNSPSC 13.2	39121522
UNSPSC 18.0	39121421
UNSPSC 19.0	39121421
UNSPSC 20.0	39121421
UNSPSC 21.0	39121421