

DIN rail mounting frame - HC-CIF-B24-BFWD-FH-AL - 1404212

Please be informed that the data shown in this PDF Document is generated from our Online Catalog. Please find the complete data in the user's documentation. Our General Terms of Use for Downloads are valid (<http://phoenixcontact.com/download>)



HEAVYCON DIN rail mounting frame, lower part with double locking latch, for sleeve housing without double locking latch or HC-CIF-.HFFD.. upper part, for type B24 contact inserts, for NS35/7,5 DIN rails

Your advantages

- ✓ Sturdy metal version
- ✓ Open base, pre-assembled cable harnesses can be used
- ✓ Standardized design; both PE sheets for inserts are connected conductively
- ✓ Safe capacitive PE even when connected slightly askew



Key Commercial Data

| | |
|--------------------------------------|---|
| Packing unit | 1 pc |
| GTIN |  4 046356 680240 |
| GTIN | 4046356680240 |
| Weight per Piece (excluding packing) | 220.000 g |
| Custom tariff number | 85389099 |
| Country of origin | Poland |

Technical data

Dimensions

| | |
|--------|--------|
| Length | 120 mm |
| Width | 56 mm |
| Height | 85 mm |

Ambient conditions

| | |
|---------------------------------|-------------------|
| Ambient temperature (operation) | -40 °C ... 125 °C |
|---------------------------------|-------------------|

DIN rail mounting frame - HC-CIF-B24-BFWD-FH-AL - 1404212

Technical data

General

| | |
|------------------------|--|
| Size | For B24 |
| Material | Cast aluminum, uncoated |
| Locking latch material | High-grade steel, handle: PA-GF |
| Assembly instructions | A double locking latch is not mounted, which means that an assembled cable set can be used more easily |
| Mounting type | DIN rail: 35 mm |

Environmental Product Compliance

| | |
|------------|---|
| China RoHS | Environmentally friendly use period: unlimited = EFUP-e |
| | No hazardous substances above threshold values |

Drawings

Dimensional drawing

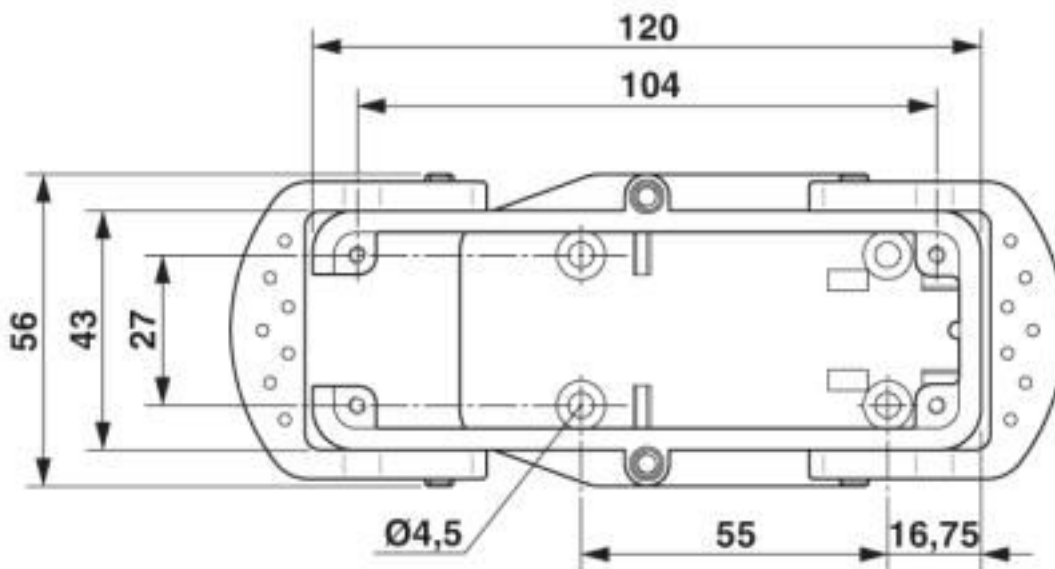

Dimensional drawing top view

DIN rail mounting frame - HC-CIF-B24-BFWD-FH-AL - 1404212

Dimensional drawing

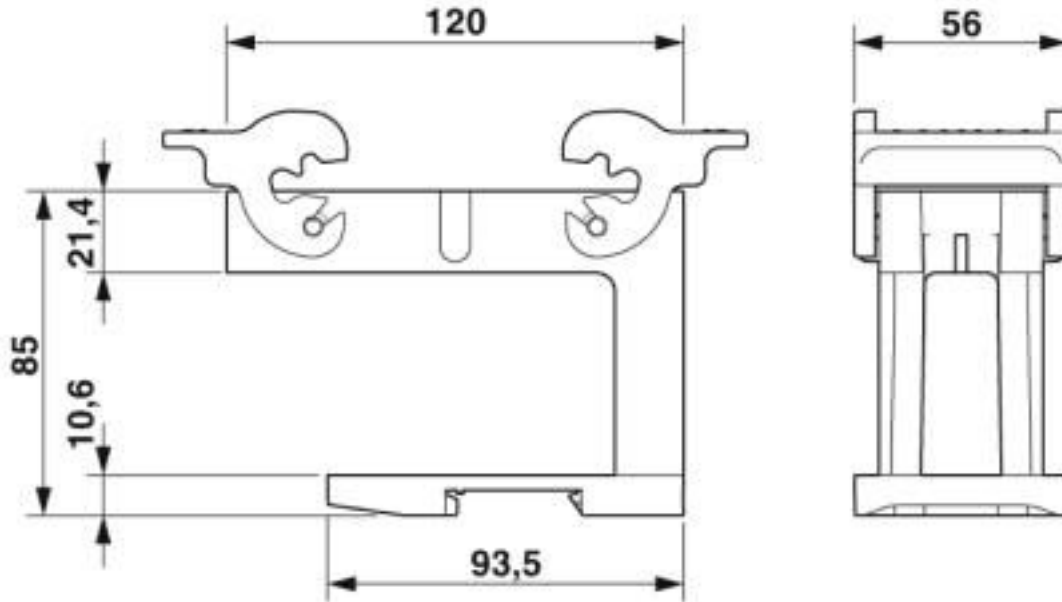

Dimensional drawing

Classifications

eCl@ss

| | |
|---------------|----------|
| eCl@ss 10.0.1 | 27440210 |
| eCl@ss 4.0 | 27140800 |
| eCl@ss 4.1 | 27140800 |
| eCl@ss 5.0 | 27143400 |
| eCl@ss 5.1 | 27143400 |
| eCl@ss 6.0 | 27261200 |
| eCl@ss 7.0 | 27440206 |
| eCl@ss 8.0 | 27440206 |
| eCl@ss 9.0 | 27440210 |

ETIM

| | |
|----------|----------|
| ETIM 3.0 | EC002310 |
| ETIM 4.0 | EC002310 |
| ETIM 5.0 | EC002310 |
| ETIM 6.0 | EC002310 |
| ETIM 7.0 | EC002310 |

DIN rail mounting frame - HC-CIF-B24-BFWD-FH-AL - 1404212

Classifications

UNSPSC

| | |
|---------------|----------|
| UNSPSC 6.01 | 43172601 |
| UNSPSC 7.0901 | 39121416 |
| UNSPSC 11 | 43172601 |
| UNSPSC 12.01 | 39121408 |
| UNSPSC 13.2 | 39121421 |
| UNSPSC 18.0 | 39121421 |
| UNSPSC 19.0 | 39121421 |
| UNSPSC 20.0 | 39121421 |
| UNSPSC 21.0 | 39121421 |

Approvals

Approvals

Approvals

EAC

Ex Approvals

Approval details

| | | |
|-----|--|--------------------------|
| EAC | | RU C- DE.AI30.B.01102 |
|-----|--|--------------------------|

Accessories

Additional products

DIN rail mounting frame - HC-CIF-B24-HFFD-WH-AL - 1404213



HEAVYCON DIN rail mounting frame, upper part for double locking latch, for HC-CIF...BFWD.. lower parts with double locking latch or for HC-CIF...BFFD.. lower parts, for type B24 contact inserts, with M4 screws with 3 mm Allen screw head, for NS35/7,5 DIN rails

